

SR014 - TRI-WAVE BEAM 2.5mm THK

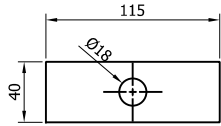

SR151 - WASHER PLATE
115 x 40 x 6 DIA.18

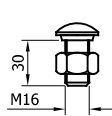

SR207 - M16x30
SETSCREW HRK
SHOULDER c/w NUT

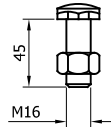

SR201 - M16x45
SETSCREW c/w NUT

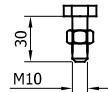

SR205 - M10x30
SETSCREW c/w NUT



SR209 - M16
WASHER 18ø HOLE
x 38



SR300 - M16
WASHER 18ø HOLE



SR301 - M10
WASHER 11ø HOLE

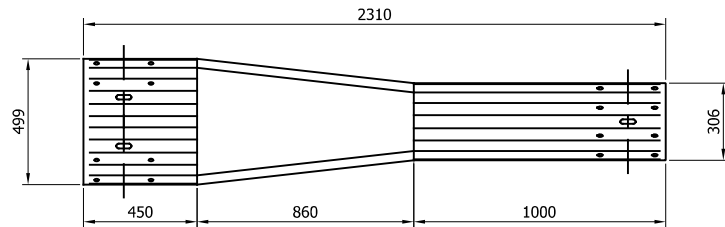

SR218 - UNIVERSAL CONNECTION FOR BOTH APPROACH & DEPARTURE
TRI-WAVE TO A PROFILE CONNECTION

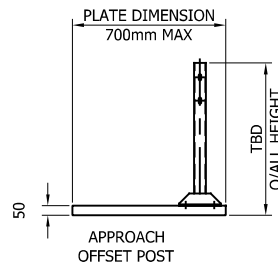

APPROACH
OFFSET POST

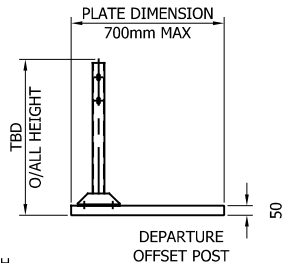

DEPARTURE
OFFSET POST

CAN BE FIXED WITH
CAST IN ANCHORS, DRILL
AND FIX ANCHORS OR
PUSHED IN ANCHORS
AT 180x180 CENTERS

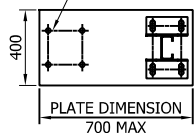

PLATE DIMENSION
700 MAX

*BASEPLATE DRILL
& TAPPED FOR
LIFTING EYE

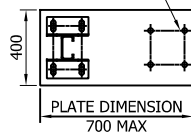
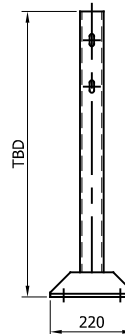
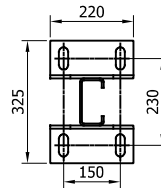
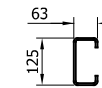
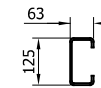
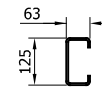
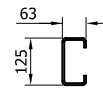

PLATE DIMENSION
700 MAX



SR485 - SURFACE
MOUNTED C125 POST

SR240 - C125 POST
1250mm

SR214 - C125 POST
1600mm

SR225 - C125 POST
2000mm

SR241 - C125 POST
2400mm

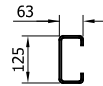

SR212 - C125
SPACER
X 275



SR100 - A21
REINFORCING
RING

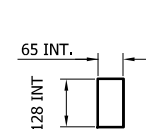

SR080 - C125
POST SOCKET
x 470

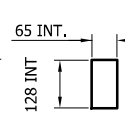

SR081 - C125
POST SOCKET
x 520

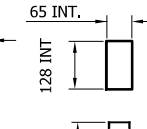

SR083 - C125
POST SOCKET
x 570

POST TYPE IDENTIFICATION

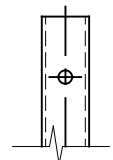
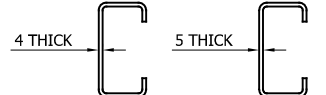

TYPE 'A'

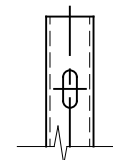

TYPE 'C'

REVn	DATE	DETAILS	INITIAL
08	23/07/24	DRAWING UPDATED	H.B
07	27.06.22	TRI WAVE BEAM NOTES CHANGED	A,D
06	13/05/22	SURFACE MOUNTED POST BASE CHANGED	A,D
05	23/07/21	NOTE CHANGE	A,D
04	27/05/21	DETAILS REVISED	M,T
03	12/02/19	DETAILS REVISED	M,T
02	17/01/18	POST LENGTH REVISED TO 1250 LONG	H,B
01	28/03/17	POST TYPE REVISED	L,L
00	14/03/17	DRAWING CREATED	L,L

SafeStar 231 H2 W3 VI 3 COMPONENT DETAILS



CONCORD HOUSE,
BESSEMER WAY, SCUNTHORPE,
NORTH LINCOLNSHIRE, DN15 8XE
t: 01724 289119
FOR TECHNICAL ASSISTANCE CONTACT
john.cudlipp@saferoad.co.uk

REVn	DATE	DETAILS	INITIAL
------	------	---------	---------

H2W3-GA-00

08

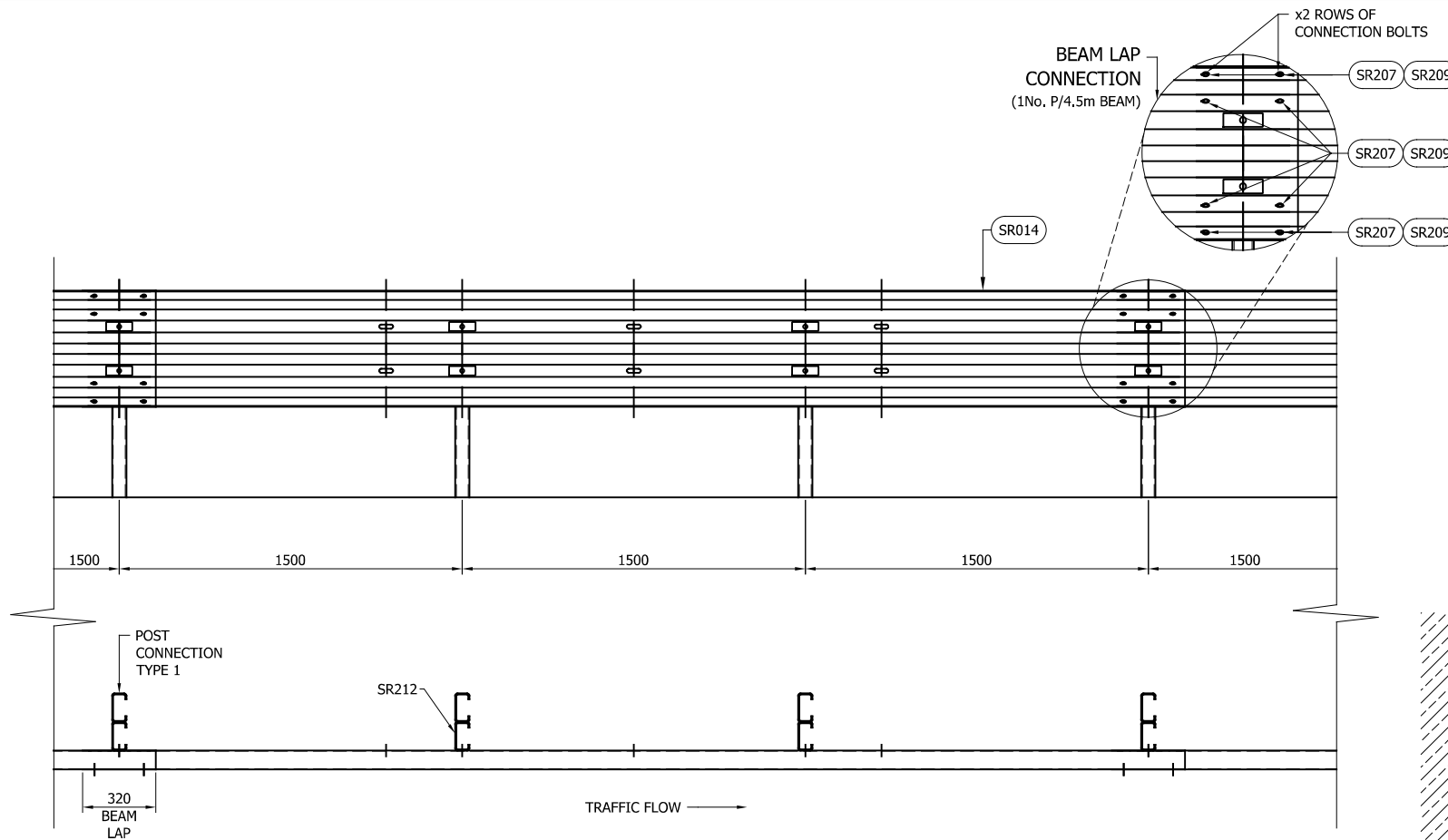

GENERAL NOTES:

1. POSTS ARE TO BE INSTALLED WITH THE CLOSED FACE OF THE CHANNEL TOWARDS THE ON-COMING TRAFFIC.
2. FOR OPTIONS ON POST FOUNDATIONS REFER TO DRAWING NUMBER MR-GA-020
3. FOR DEVIATIONS IN SYSTEM POST PITCH REFER TO DRAWING H2W3-GA-40.
4. WHEN TYING INTO ADJACENT VRS ONLY ONE WORKING WIDTH DIFFERENCE IS PERMITTED. SEE SYSTEM PROGRESSION DETAILS.
5. WHERE A KERB IS PRESENT THE MAXIMUM KERB HEIGHT IS 100mm. SHOULD THE KERB BE HIGHER THAN 100mm AND THE FENCE IS SETBACK LESS THAN 250mm FROM THE FACE OF THE KERB. THE SYSTEM HEIGHT IS MEASURED FROM THE CARRIAGEWAY. IF THE SETBACK IS MORE THAN 250mm FROM THE FACE OF KERB THE SYSTEM HEIGHT IS MEASURED FROM THE TOP OF THE KERB.
6. FOR MINIMUM LENGTH OF FULL HEIGHT VRS REFER TO SAFEROAD MEGARAIL MANUAL.

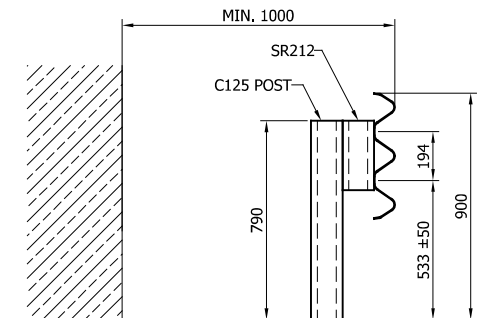

TABLE 'A' - SYSTEM COMPONENT SCHEDULE - QUANTITIES / 4.5m BEAM

SAFEROAD UK PART NUMBER	DESCRIPTION	QUANTITY
SR014	TRI-WAVE BEAM	1
SR212	C125 SPACER BRACKET	3
SEE TABLE 'B'	C125 POST	3
FOR SCHEDULE OF BOLTED CONNECTIONS REFER TO DRAWING NUMBER H2W3-GA-02		

TABLE 'B' - SCHEDULE OF POST REFERENCE NUMBERS AND LENGTHS

SAFEROAD UK PART NUMBER	POST LENGTH
SR240	1250
SR214	1600
SR225	2000
SR241	2400
SR485	SURFACE MOUNTED POST

SafeStar 231 H2 W3 VI 3

GENERAL ARRANGEMENT & SETTING OUT DETAILS



CONCORD HOUSE,
BESSEMER WAY, SCUNTHORPE,
NORTH LINCOLNSHIRE, DN15 8XE
t: 01724 289119
FOR TECHNICAL ASSISTANCE CONTACT
john.cudlipp@saferoad.co.uk

06	23/07/24	DRAWING UPDATED	H.B
05	15/02/23	NOTE REMOVED	A.D
04	18/11/22	NOTE REMOVED	A.D
03	16/08/21	TABLE 'A' REVISED	A.D
02	12/02/19	TITLEBLOCK REVISED	M.T
01	28/03/17	BEAM DETAIL AND DIM REV	L.L
00	14/03/17	DRAWING CREATED	L.L
REVn	DATE	DETAILS	INITIAL

DRAWING NUMBER:	REVn:
H2W3-GA-01	06

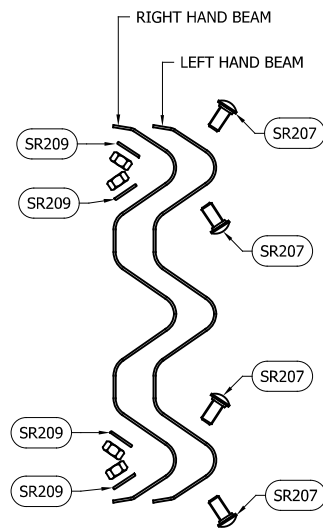

**BEAM LAP CONNECTION
DETAILS**
(1No. LOCATION P/BEAM END)

BEAM LAP FIXINGS		
SAFEROAD UK PART NUMBER	DESCRIPTION	QUANTITY
SR207	M16x30 SETSCREW HRK SHOULDER c/w NUT	8 (+8)
SR209	M16 WASHER 18Ø HOLE x 38	8 (+8)

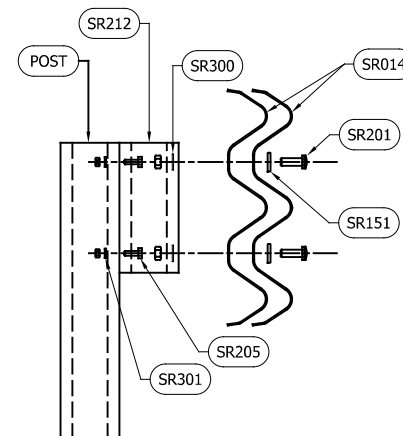

**POST TO BEAM
CONNECTION DETAILS**
(PER POST)

POST TO BEAM FIXINGS		
SAFEROAD UK PART NUMBER	DESCRIPTION	QUANTITY
SR201	M16x45 SETSCREW c/w NUT	2
SR151	WASHER PLATE 115 x 40 x 6 DIA. 18	2
SR300	M16 WASHER 18Ø HOLE	2
SR205	M10x30 SETSCREW c/w NUT	2
SR301	M10 WASHER 11Ø HOLE	2

- GENERAL NOTES:
- NUMBERS IN THE SCHEDULES SUFFIXED (+) DENOTES THE ADDITIONAL QUANTITY OF COMPONENTS REQUIRED FOR EXTREME ENDS OF INDIVIDUAL RUNS OF BARRIER.

REVn	DATE	DETAILS	INITIAL
03	23/07/24	DRAWING UPDATED	H.B
02	16/08/21	BEAM LENGTH NOTE CHANGED FROM 4m TO 4.5m	A.D
01	12/02/19	TITLEBLOCK REVISED	M.T
00	14/03/17	DRAWING CREATED	L.L

SafeStar 231
H2 W3 VI 3
FIXINGS SCHEMATIC



CONCORD HOUSE,
BESSEMER WAY, SCUNTHORPE,
NORTH LINCOLNSHIRE, DN15 8XE
t: 01724 289119
FOR TECHNICAL ASSISTANCE CONTACT
john.cudlipp@saferoad.co.uk

DRAWING NUMBER:	REVn:
H2W3-GA-02	03

** BEAM REFERENCES i.e. LEFT / RIGHT HAND ARE FOR VERGE INSTALLATIONS; FOR CENTRAL RESERVATION INSTALLATIONS THE REFERENCES ARE REVERSED

- GENERAL NOTES:
1. POSTS ARE TO BE INSTALLED WITH THE CLOSED FACE OF THE CHANNEL TOWARDS THE ON-COMING TRAFFIC.

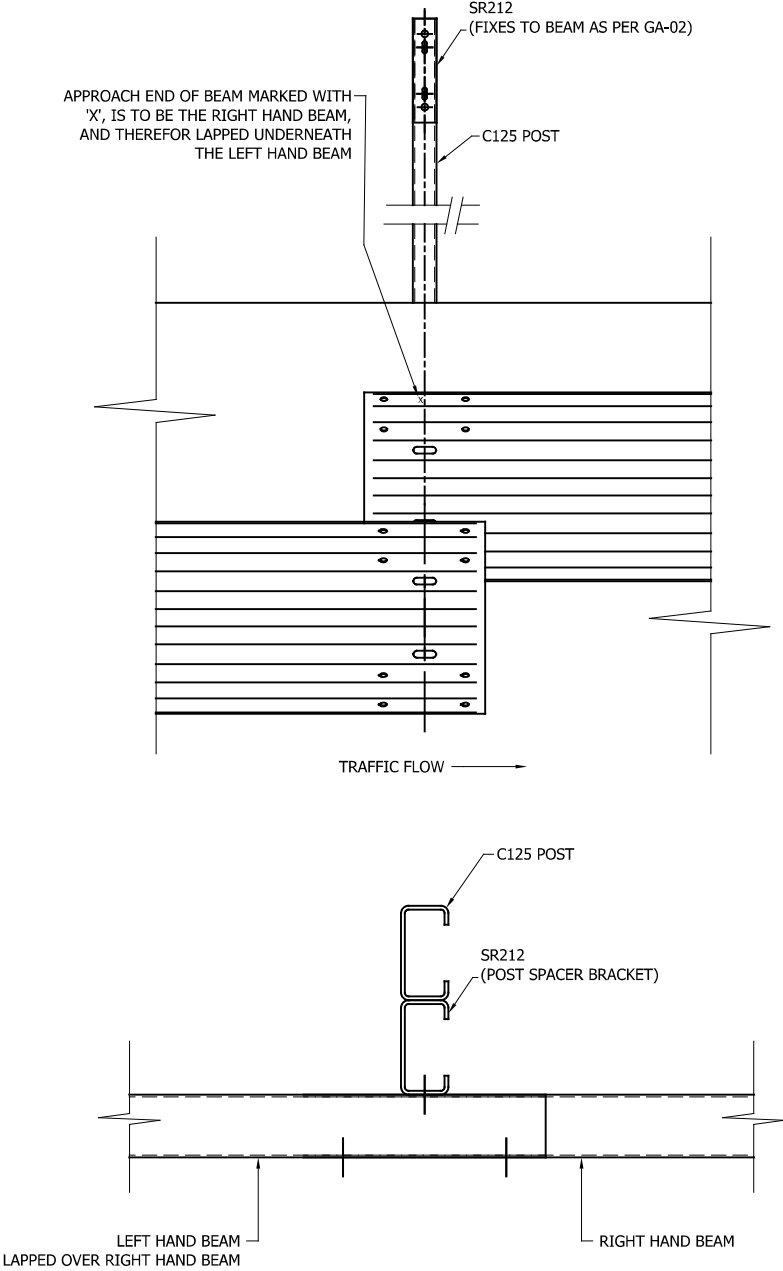

REVn	DATE	DETAILS	INITIAL
03	23/07/24	DRAWING UPDATED	H.B
02	27/06/22	NOTES CHANGED	A.D
01	12/02/19	TITLEBLOCK REVISED	M.T
00	14/03/17	DRAWING CREATED	L.L

SafeStar 231
H2 W3 VI 3
BEAM LAPPING DETAILS



CONCORD HOUSE,
BESSEMER WAY, SCUNTHORPE,
NORTH LINCOLNSHIRE, DN15 8XE
t: 01724 289119
FOR TECHNICAL ASSISTANCE CONTACT
john.cudlipp@saferoad.co.uk

DRAWING NUMBER:	REVn:
H2W3-GA-03	03

** BEAM REFERENCES i.e. LEFT / RIGHT HAND ARE FOR VERGE INSTALLATIONS; FOR CENTRAL RESERVATION INSTALLATIONS THE REFERENCES ARE REVERSED

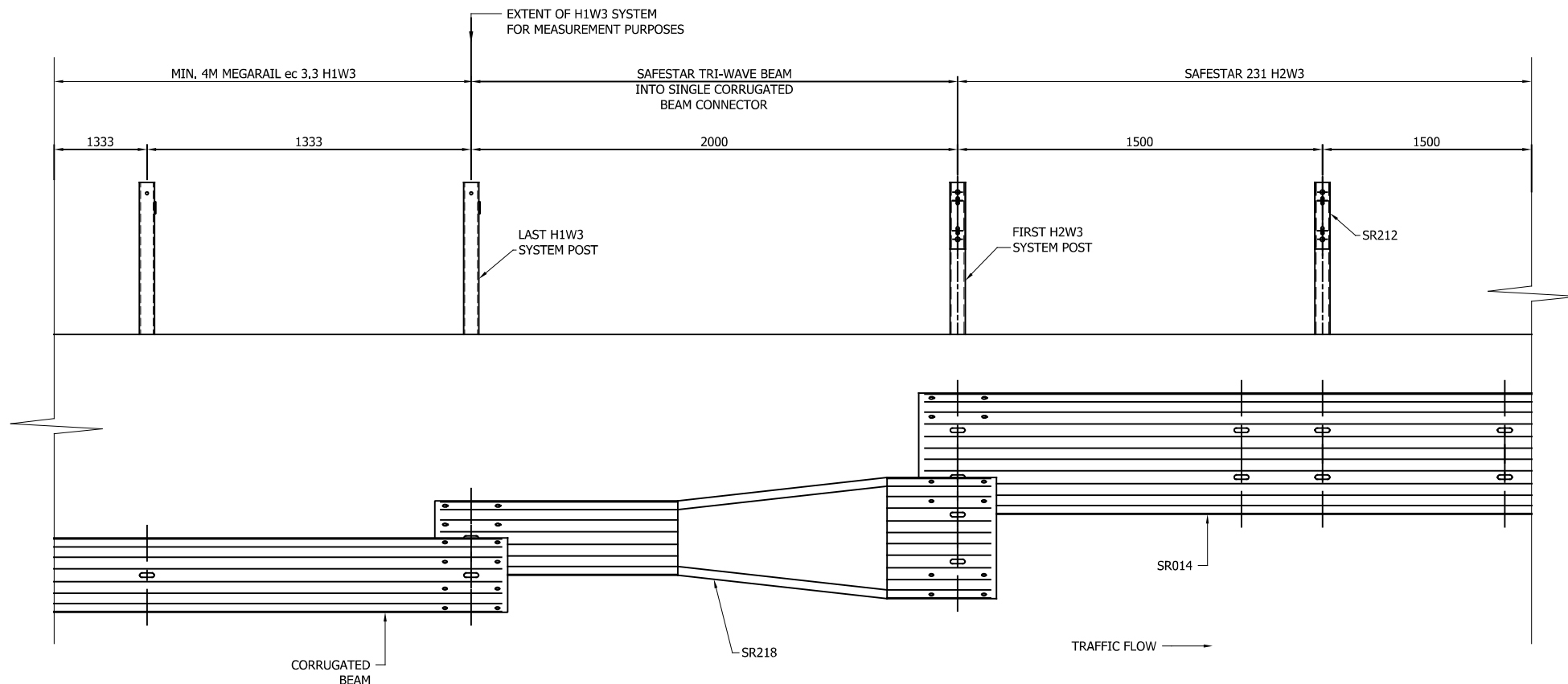

GENERAL NOTES:

1. POSTS ARE TO BE INSTALLED WITH THE CLOSED FACE OF THE CHANNEL TOWARDS THE ON-COMING TRAFFIC.

** BEAM REFERENCES i.e. LEFT / RIGHT HAND ARE FOR VERGE INSTALLATIONS; FOR CENTRAL RESERVATION INSTALLATIONS THE REFERENCES ARE REVERSED

SafeStar 231 H2 W3 VI 3

W3 SYSTEM PROGRESSION DETAILS



CONCORD HOUSE,
BESSEMER WAY, SCUNTHORPE,
NORTH LINCOLNSHIRE, DN15 8XE
t: 01724 289119
FOR TECHNICAL ASSISTANCE CONTACT
john.cudlipp@saferoad.co.uk

04	23/07/24	DRAWING UPDATED	H.B
03	27/06/22	NOTES REMOVED	A.D
02	08/10/21	DETAILS REVISED	A.D
01	12/02/19	TITLEBLOCK REVISED	M.T
00	14/03/17	DRAWING CREATED	L.L
REVn	DATE	DETAILS	INITIAL

DRAWING NUMBER:	REVn:
H2W3-GA-20	04

GENERAL NOTES:

1. IF THE SITE CONDITIONS DO NOT ALLOW A POST TO BE INSTALLED ON THE SYSTEM PITCH DEVIATIONS CAN BE APPLIED. THE OBSTRUCTED POST CAN BE LEFT OUT AND EXTRA POSTS INSTALLED TO SPAN THE OBSTRUCTION AS PER THIS DRAWING. ALTHOUGH IT WOULD BE BENEFICIAL TO USE THE HOLES ALREADY IN THE BEAM IT IS ACCEPTABLE TO DRILL NEW HOLES IN THE DESIRED POSITIONS AND TREAT WITH ZINC RICH PAINT.
2. OFFSET POSTS SHOWN ON DRAWING H2W3-GA-00 CAN BE USED.

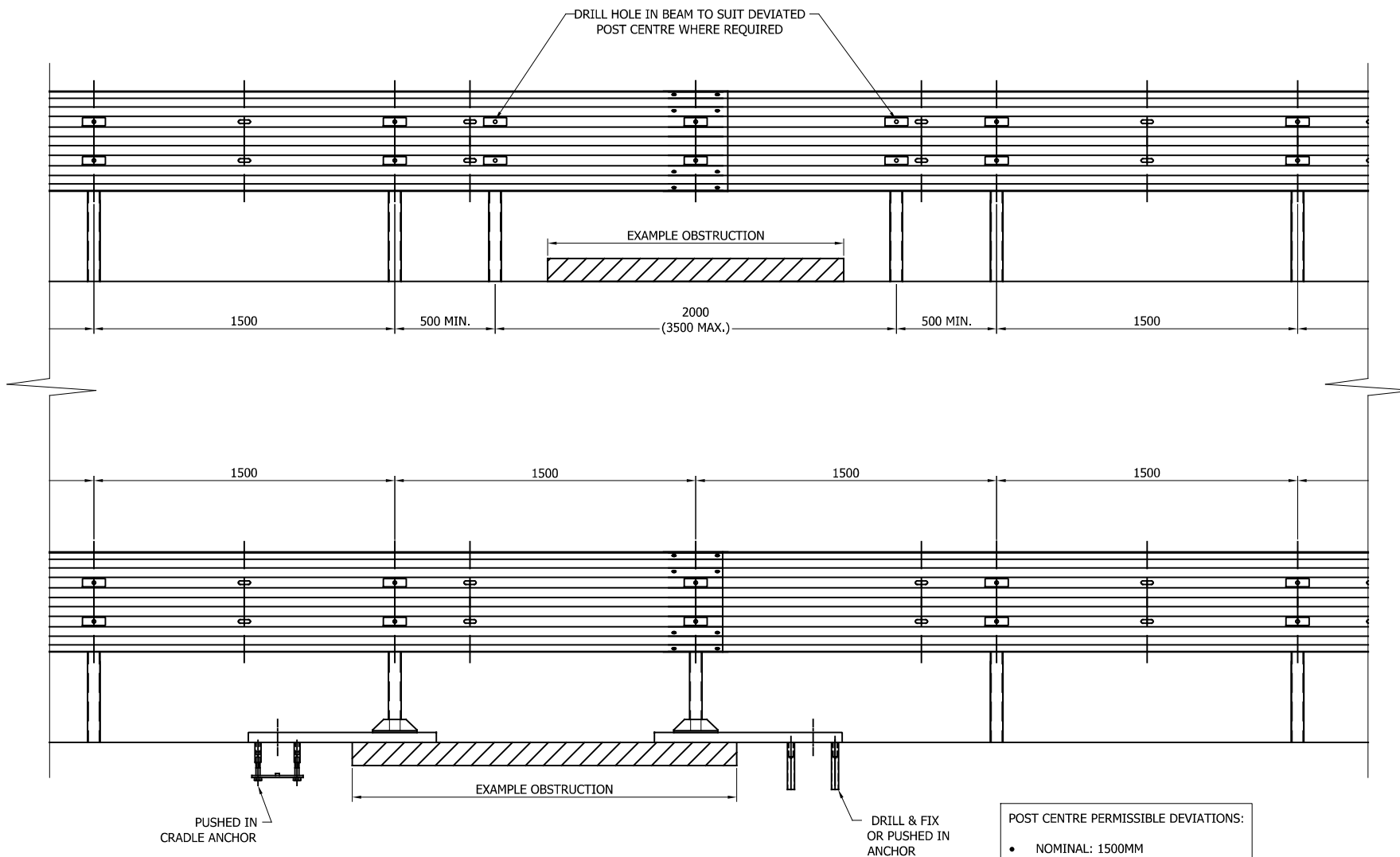

POST CENTRE PERMISSIBLE DEVIATIONS:

- NOMINAL: 1500MM
- MAXIMUM: 3500MM
- MINIMUM: 500MM

04	23/07/24	DRAWING UPDATED	H.B
03	13/05/22	SURFACE MOUNTED POST BASE CHANGED	A.D
02	23/07/21	SURFACE MOUNTED POST DETAILS ADDED	A.D
01	12/02/17	DETAILS REVISED	M.T
00	14/03/17	DRAWING CREATED	L.L
REVn	DATE	DETAILS	INITIAL

SafeStar 231

H2 W3 VI 3

PERMISSIBLE DEVIATION SETTING
OUT DETAILS



CONCORD HOUSE,
BESSEMER WAY, SCUNTHORPE,
NORTH LINCOLNSHIRE, DN15 8XE
t: 01724 289119
FOR TECHNICAL ASSISTANCE CONTACT
john.cudlipp@saferoad.co.uk

DRAWING NUMBER:	REVn:
H2W3-GA-40	04

- GENERAL NOTES:
1. POSTS ARE TO BE INSTALLED WITH THE CLOSED FACE OF THE CHANNEL TOWARDS THE ON-COMING TRAFFIC.
 2. FOR FURTHER DETAILS OF SYSTEM PROGRESSION SEE, H2W3-GA-20 & MEGARAIL MANUAL

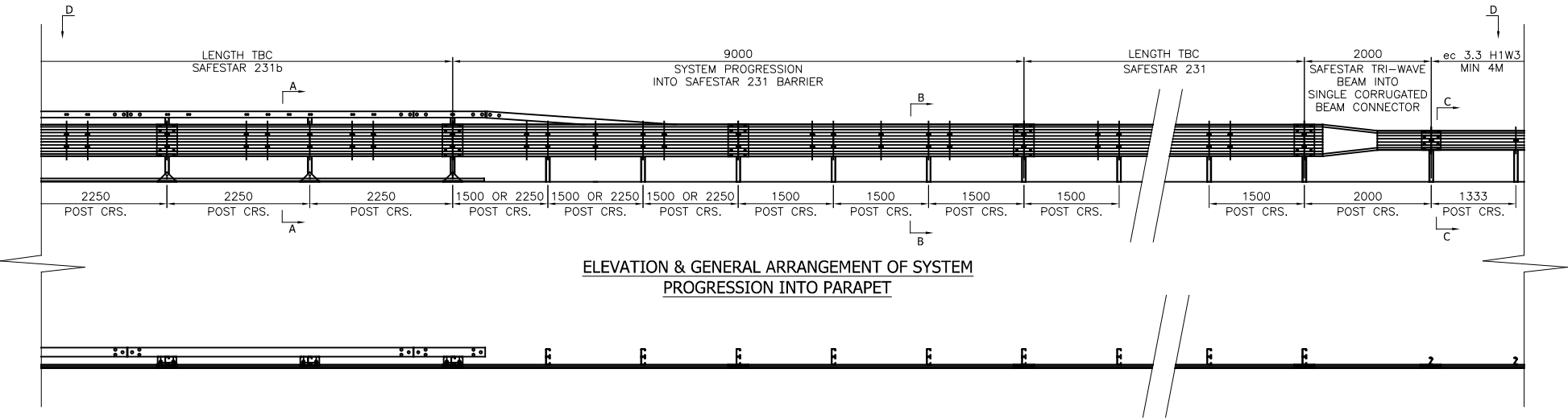

SECTION D-D
(PLAN VIEW ON SYSTEM PROGRESSION)

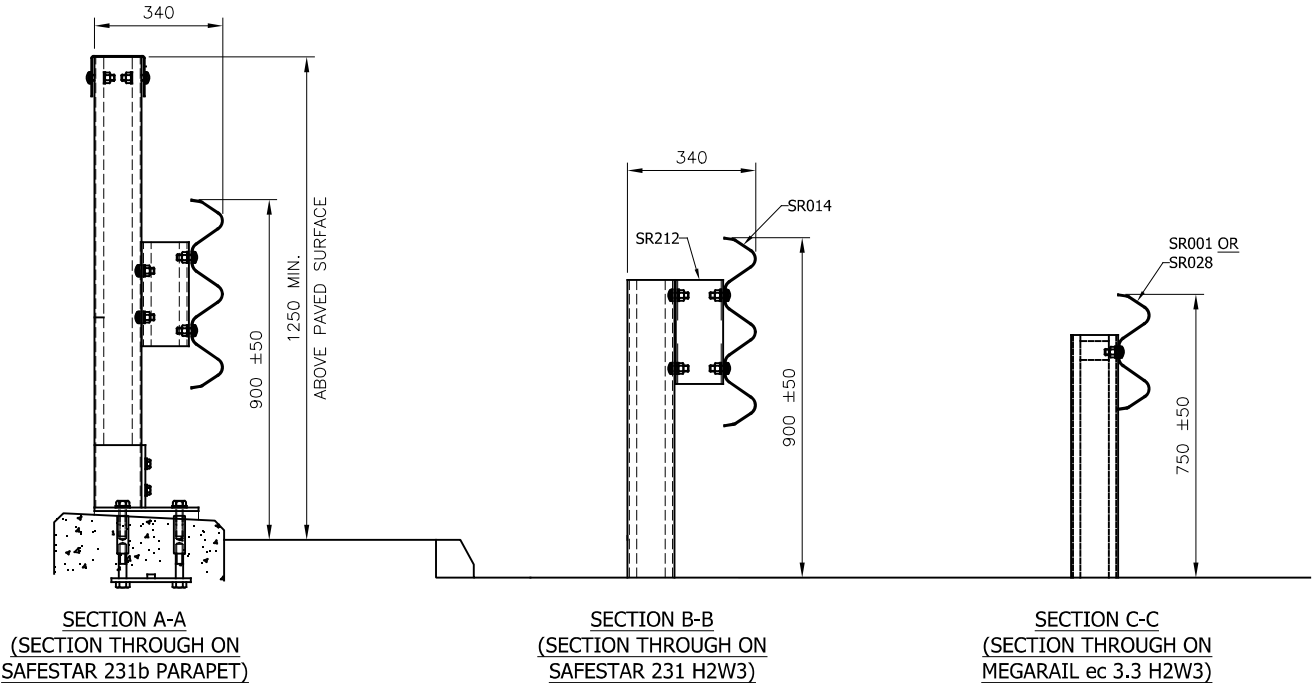

SafeStar 231
H2 W3 VI 3
SYSTEM PROGRESSION INTO
SAFESTAR 231b PARAPET



CONCORD HOUSE,
BESSEMER WAY, SCUNTHORPE,
NORTH LINCOLNSHIRE, DN15 8XE
t: 01724 289119
FOR TECHNICAL ASSISTANCE CONTACT
john.cudlipp@saferoad.co.uk

05	23/07/24	DRAWING UPDATED	H.B
04	14/04/23	TRANSITION DETAILS UPDATED	H.B
03	12/02/19	TITLEBLOCK REVISED	M.T
02	20/04/17	MESH RAIL REMOVED	L.L
01	28/03/17	DETAILS REVISED	L.L
00	14/03/17	DRAWING CREATED	L.L
REVn	DATE	DETAILS	INITIAL

H2W3-GA-50

05

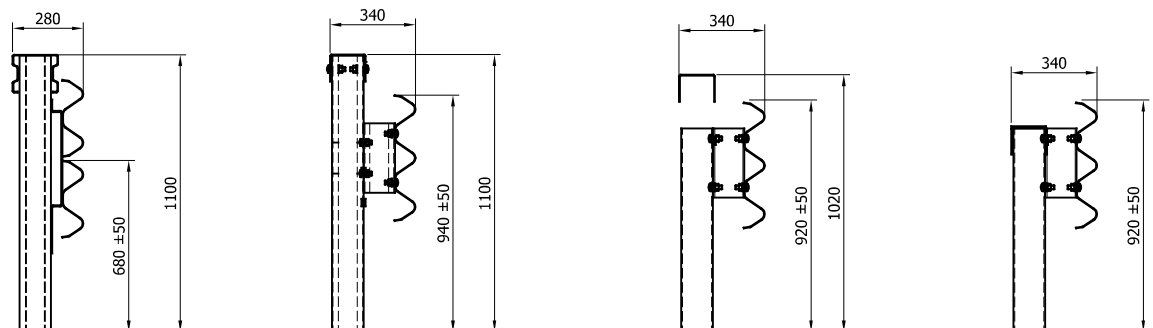
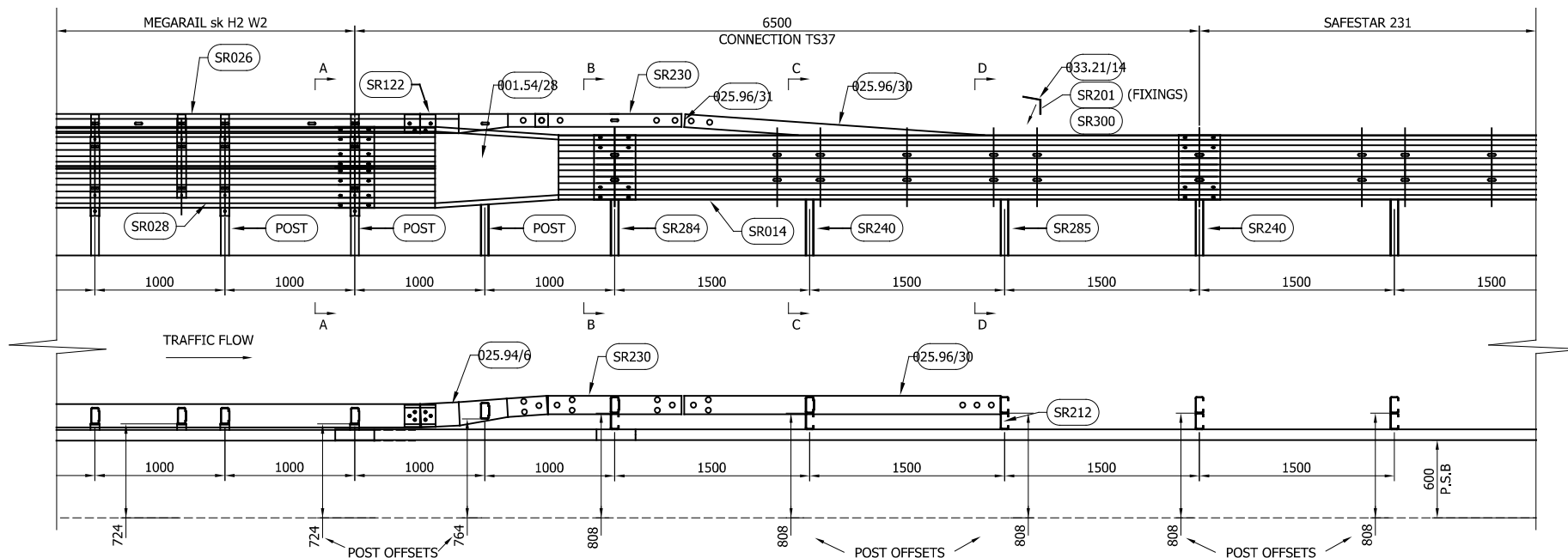

SECTION A-A

SECTION B-B

SECTION C-C

SECTION D-D

GENERAL NOTES:

1. TO BE READ IN CONJUNCTION WITH DRG.
Nos. H2W3-GA-00, H2W3-GA-01 &
H2W3-GA-02.
2. DEPARTURE CONNECTION SHOWN, APPROACH
SIMILAR BUT HANDED. CODES AS SHOWN.

POST LENGTHS DETAILED WITHIN GA & TABLE ARE
EXAMPLES OF LENGTHS AVAILABLE. LENGTH/FOUNDATION
VARIATIONS ARE AVAILABLE AS SHOWN ON GA-00, AS
REQUIRED VIA SOIL TESTING PROCEDURE

TABLE 'A' - TRANSITION COMPONENT SCHEDULE - QTY'S 1 No. DEPARTURE TRANSITION		
SAFEROAD PART NUMBER	DESCRIPTION	QUANTITY
001.54/27	sk TO TRI-WAVE BEAM APPROACH	0
001.54/28	sk TO TRI-WAVE BEAM DEPARTURE	1
025.94/6	sk TO SAFESTAR TRANSITION TOP RAIL	1
SR230	SAFESTAR TOP RAIL 1100	1
025.96/30	LOWERING END TOP RAIL	1
SR212	SAFESTAR SPACER 275	4
SR028	sk BEAM "A" PROFILE	2
SR014	TRI-WAVE BEAM	1
033.21/14	ATTACHMENT ANGLE	1
SK POST	SEE MEGARAIL SK GA-00 FOR POST LENGTHS	3
SR284	'C' POST 125 x 1600 LONG cw CONN.	1
SR240	'C' POST 125 x 1250 LONG SAFESTAR	2
SR285	'C' POST 125 x 1250 LONG SAFESTAR w CONN.	1
FOR SCHEDULE OF BOLTED CONNECTIONS REFER TO DRAWING NUMBER H2W3-GA-02 & MEGARAIL sk GA H2W2-GA-02		

07	23/07/24	DRAWING UPDATED	H.B
06	11/03/24	NOTE REGARDING POST LENGTHS ADDED	H.B
05	03.08.23	DETAILS UPDATED	H.B
04	11.01.23	TOP RAIL JOINT CODE CHANGED	A.D
03	08.12.21	PLAN VIEW ALTERED	A.D
02	25.05.21	DETAILS REVISED	M.T
01	12.02.19	TITLEBLOCK REVISED	M.T
REVn	DATE	DETAILS	INITIAL

SafeStar 231
H2 W3 VI 3
DETAILS OF CONNECTION INTO
H2W2 MEGARAIL SK



CONCORD HOUSE,
BESSEMER WAY, SCUNTHORPE,
NORTH LINCOLNSHIRE, DN15 8XE
t: 01724 289119
FOR TECHNICAL ASSISTANCE CONTACT
john.cudlipp@saferoad.co.uk

DRAWING NUMBER:

H2W3-GA-51

REVn:

07

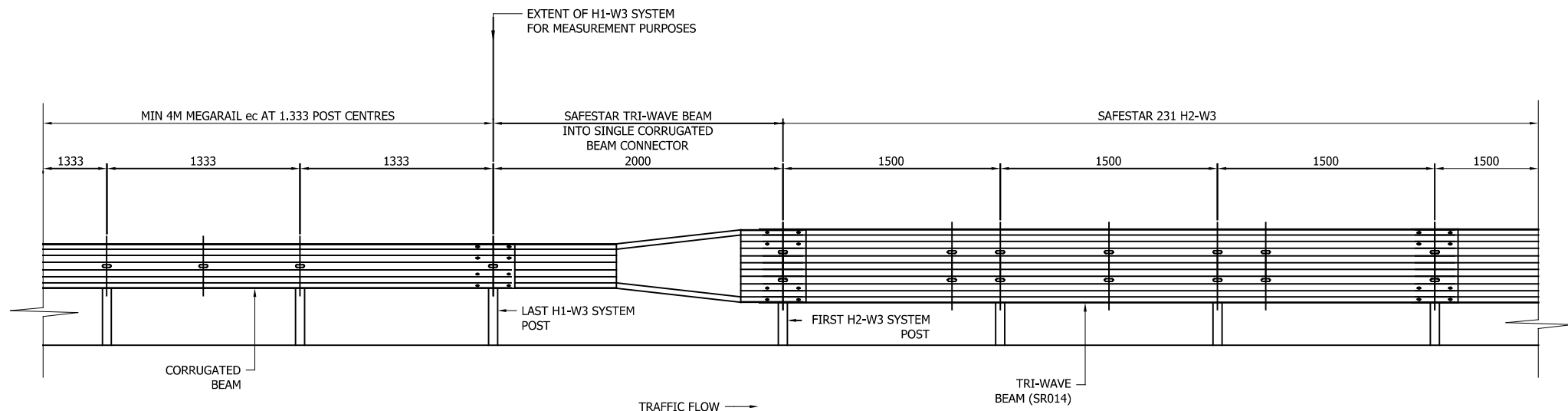

SafeStar 231 H2 W3 VI 3

SYTSEM PROGRESSION FOR W3
PROTECTION TO HAZARD



CONCORD HOUSE,
BESSEMER WAY, SCUNTHORPE,
NORTH LINCOLNSHIRE, DN15 8XE
t: 01724 289119
FOR TECHNICAL ASSISTANCE CONTACT
john.cudlipp@saferoad.co.uk

GENERAL NOTES:

1. POSTS ARE TO BE INSTALLED WITH THE CLOSED FACE OF THE CHANNEL TOWARDS THE ON-COMING TRAFFIC.

** BEAM REFERENCES i.e. LEFT / RIGHT HAND ARE FOR VERGE INSTALLATIONS; FOR CENTRAL RESERVATION INSTALLATIONS THE REFERENCES ARE REVERSED

01	23/07/24	DRAWING UPDATED	H.B
00	14/11/23	DRAWING CREATED	H.B
REVn	DATE	DETAILS	INITIAL

DRAWING NUMBER:	REVn:
H2W3-GA-52	01