

SR022 - BEAM
2.4MM BEAM ONLY - HAS ID HOLES AT TEAR DROP ENDS OF BEAM

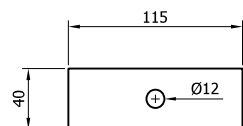

SR152 - WASHER PLATE 115
x 40 x 5 DIA.12

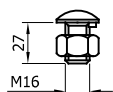

SR200 - SETSCREW 4.6
LIP M16x27 c/w NUT

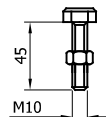

SR124 - SETSCREW
M10x45 c/w NUT

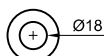

SR300 - M16
WASHER 18ø HOLE



SR301 - M10
WASHER 11ø HOLE

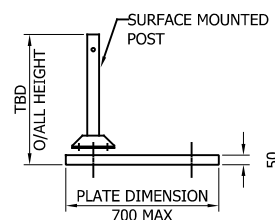
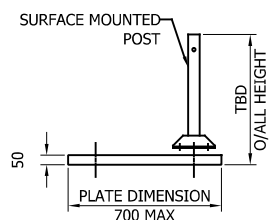

CAN BE FIXED WITH
CAST IN ANCHORS, DRILL
AND FIX ANCHORS OR
PUSHED IN ANCHORS
AT 180x180 CENTERS

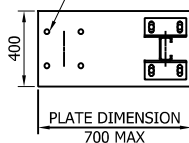

BASEPLATE DRILL &
TAPPED FOR LIFTING EYE

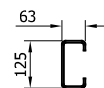
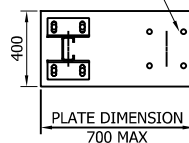

SR040 - TYPE 'A' POST
"C" 125 2400mm

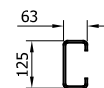

SR035 - TYPE 'A' POST
"C" 125 1800mm

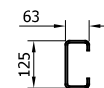

SR034 - TYPE 'A' POST
"C" 125 1100mm

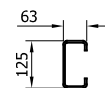

SR036 - TYPE 'A' POST
"C" 125 2000mm

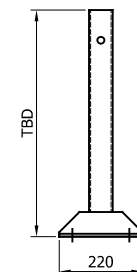
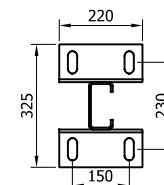

SURFACE MOUNTED -
TYPE 'A' C-125 POST

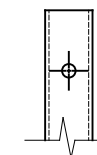
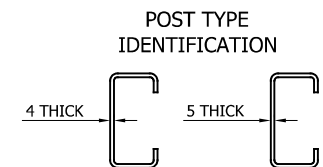

TYPE 'A'

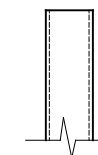

TYPE 'B'

| | | | |
|------|----------|--------------------------------------|---------|
| 07 | 21/05/24 | BEAM SLOT DETAILS UPDATED | H.B |
| 06 | 13/05/22 | SURFACE MOUNTED POST BASE CHANGED | A.D |
| 05 | 27/05/21 | DETAILS REVISED | M.T |
| 04 | 12/02/19 | TITLEBLOCK REVISED | H.B |
| 03 | 10/03/17 | DETAILS REVISED | L.L |
| 02 | 01/02/17 | DETAILS REVISED | L.L |
| 1.2 | 20/05/15 | DETAILS REVISED | M.T |
| REVn | DATE | DETAILS | INITIAL |

MegaRail em H1 W4 (VI 4)

H1.W4 VEHICLE RESTRAINT SYSTEM
COMPONENTS SCHEMATIC



CONCORD HOUSE,
BESSEMER WAY, SCUNTHORPE,
NORTH LINCOLNSHIRE, DN15 8XE
t: 01724 289119
e: john.cudlipp@saferoad.co.uk

DRAWING NUMBER:

H1W4-GA-00

REVn:

07



SR100 - A21
REINFORCING
RING

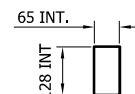

SR080 - C-125
POST SOCKET
x 470

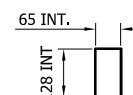

SR081 - C-125
POST SOCKET
x 520

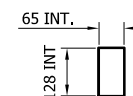

SR083 - C-125
POST SOCKET
x 570

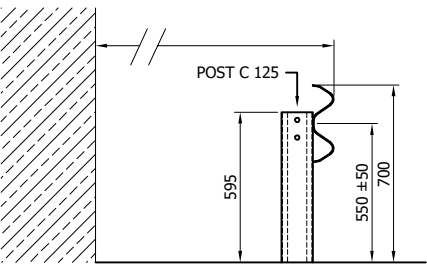
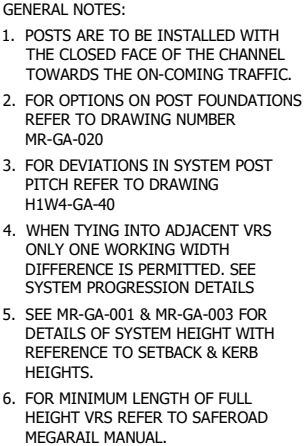

| SAFEROAD UK PART NUMBER | POST LENGTH |
|-------------------------|-------------|
| SR034 | 1100 |
| SR035 | 1800 |
| SR036 | 2000 |
| SR040 | 2400 |

| | | | |
|------|----------|---------------------------|---------|
| 05 | 21/05/24 | BEAM SLOT DETAILS UPDATED | H.B |
| 04 | 12/02/19 | TITLEBLOCK REVISED | H.B |
| 03 | 12/02/17 | DETAILS REVISED | L.L |
| 02 | 01/02/17 | DETAILS REVISED | L.L |
| 1.2 | 20/05/15 | DETAILS REVISED | M.T |
| REVn | DATE | DETAILS | INITIAL |

H1.W4 VEHICLE RESTRAINT SYSTEM ASSEMBLY AND SETTING OUT ARRANGEMENT

CONCORD HOUSE,
BESSEMER WAY, SCUNTHORPE,
NORTH LINCOLNSHIRE, DN15 8XE
t: 01724 289119
e: john.cudlipp@saferoad.co.uk

REVn:

05

- GENERAL NOTES:
1. NUMBERS IN THE SCHEDULES SUFFIXED (+) DENOTES THE ADDITIONAL QUANTITY OF COMPONENTS REQUIRED FOR EXTREME ENDS OF INDIVIDUAL RUNS OF BARRIER.

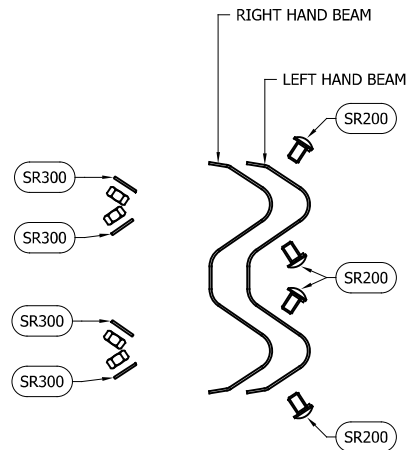

BEAM TO BEAM CONNECTION
ARRANGEMENT
(x2 LOCATIONS / BEAM END)

| BOLTING COMPONENT SCHEDULE - QUANTITIES / BEAM | | |
|--|---------------------------------|-------------------------|
| SAFEROAD UK PART NUMBER | DESCRIPTION | BEAM TO BEAM CONNECTION |
| SR200 | SETSCREW 4.6 LIP M16x27 c/w NUT | 8 (+8) |
| SR300 | WASHER M16 18Ø HOLE | 8 (+8) |

** BEAM REFERENCES i.e. LEFT / RIGHT HAND ARE FOR VERGE INSTALLATIONS; FOR CENTRAL RESERVATION INSTALLATIONS THE REFERENCES ARE REVERSED

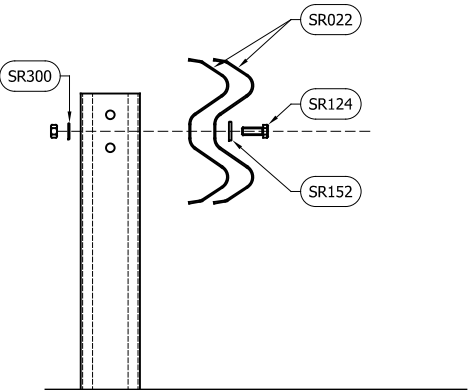

BEAM TO POST
CONNECTION TYPE 1

| BOLTING COMPONENT SCHEDULE - QUANTITIES / POST | | |
|--|-----------------------------------|-------------------|
| SAFEROAD UK PART NUMBER | DESCRIPTION | TYPE 1 CONNECTION |
| SR124 | SETSCREW 8.8 M10 x 45 c/w NUT | 2 |
| SR152 | WASHER PLATE 115 x 40 x 5 DIA. 12 | 2 |
| SR301 | WASHER M10 12Ø HOLE | 2 |

MegaRail em H1 W4 (VI 4)

H1.W4 VEHICLE RESTRAINT SYSTEM
BOLTING ARRANGEMENTS



CONCORD HOUSE,
BESSEMER WAY, SCUNTHORPE,
NORTH LINCOLNSHIRE, DN15 8XE
t: 01724 289119
e: john.cudlipp@saferoad.co.uk

| | |
|-----------------|-------|
| DRAWING NUMBER: | REVn: |
| H1W4-GA-02 | 04 |

- GENERAL NOTES:
1. POSTS ARE TO BE INSTALLED WITH THE CLOSED FACE OF THE CHANNEL TOWARDS THE ON-COMING TRAFFIC.

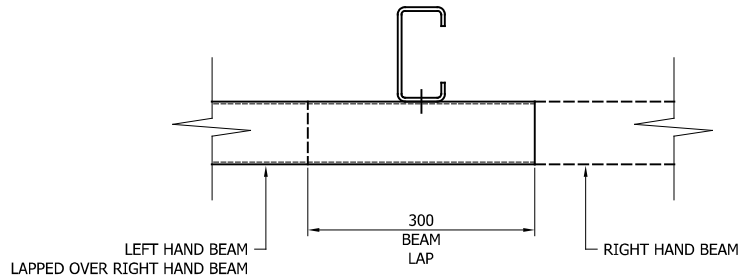
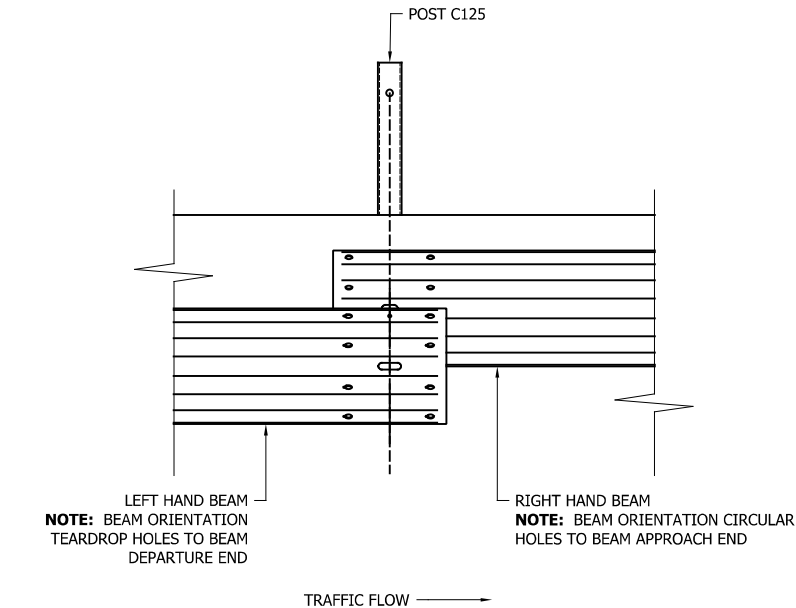

** BEAM REFERENCES i.e. LEFT / RIGHT HAND ARE FOR VERGE INSTALLATIONS; FOR CENTRAL RESERVATION INSTALLATIONS THE REFERENCES ARE REVERSED

| | | | |
|------|----------|--------------------|---------|
| 05 | 21/05/24 | DRAWING UPDATED | H.B |
| 04 | 12/02/19 | TITLEBLOCK REVISED | H.B |
| 03 | 01/02/17 | DETAILS REVISED | L.L |
| 02 | 01/02/17 | DETAILS REVISED | L.L |
| 1.2 | 20/05/15 | DETAILS REVISED | M.T |
| REVn | DATE | DETAILS | INITIAL |

MegaRail em H1 W4 (VI 4)

H1.W4 VEHICLE RESTRAINT SYSTEM.
BEAM LAPPING DETAIL FOR W4
MegaRail em SYSTEM



CONCORD HOUSE,
BESSEMER WAY, SCUNTHORPE,
NORTH LINCOLNSHIRE, DN15 8XE
t: 01724 289119
e: john.cudlipp@saferoad.co.uk

| | |
|-----------------|-------|
| DRAWING NUMBER: | REVn: |
| H1W4-GA-03 | 05 |

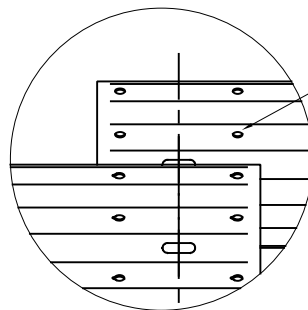
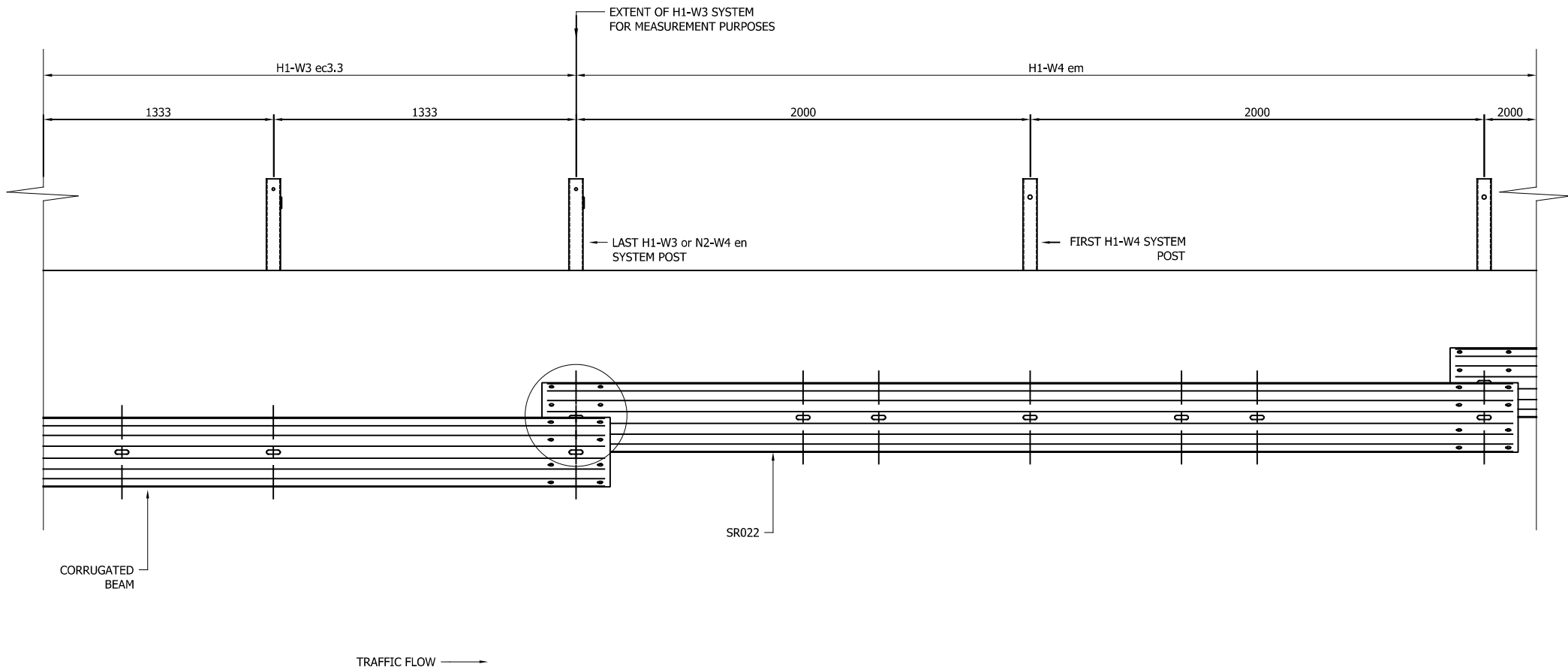

** BEAM REFERENCES i.e. LEFT / RIGHT HAND ARE FOR VERGE INSTALLATIONS; FOR CENTRAL RESERVATION INSTALLATIONS THE REFERENCES ARE REVERSED

- GENERAL NOTES:
1. POSTS ARE TO BE INSTALLED WITH THE CLOSED FACE OF THE CHANNEL TOWARDS THE ON-COMING TRAFFIC.

MegaRail em H1 W4 (VI 4)

SYSTEM PROGRESSION DETAILS



CONCORD HOUSE,
BESSEMER WAY, SCUNTHORPE,
NORTH LINCOLNSHIRE, DN15 8XE
t: 01724 289119
e: john.cudlipp@saferoad.co.uk

| REVn | DATE | DETAILS | INITIAL |
|------|----------|---------------------------|---------|
| 03 | 21/05/24 | BEAM SLOT DETAILS UPDATED | H.B |
| 02 | 12/02/19 | TITLEBLOCK REVISED | H.B |
| 01 | 10/03/17 | POST DETAILS REVISED | L.L |
| 00 | 02/02/17 | NEW DRAWING | L.L |

| | |
|-----------------|-------|
| DRAWING NUMBER: | REVn: |
| H1W4-GA-20 | 03 |

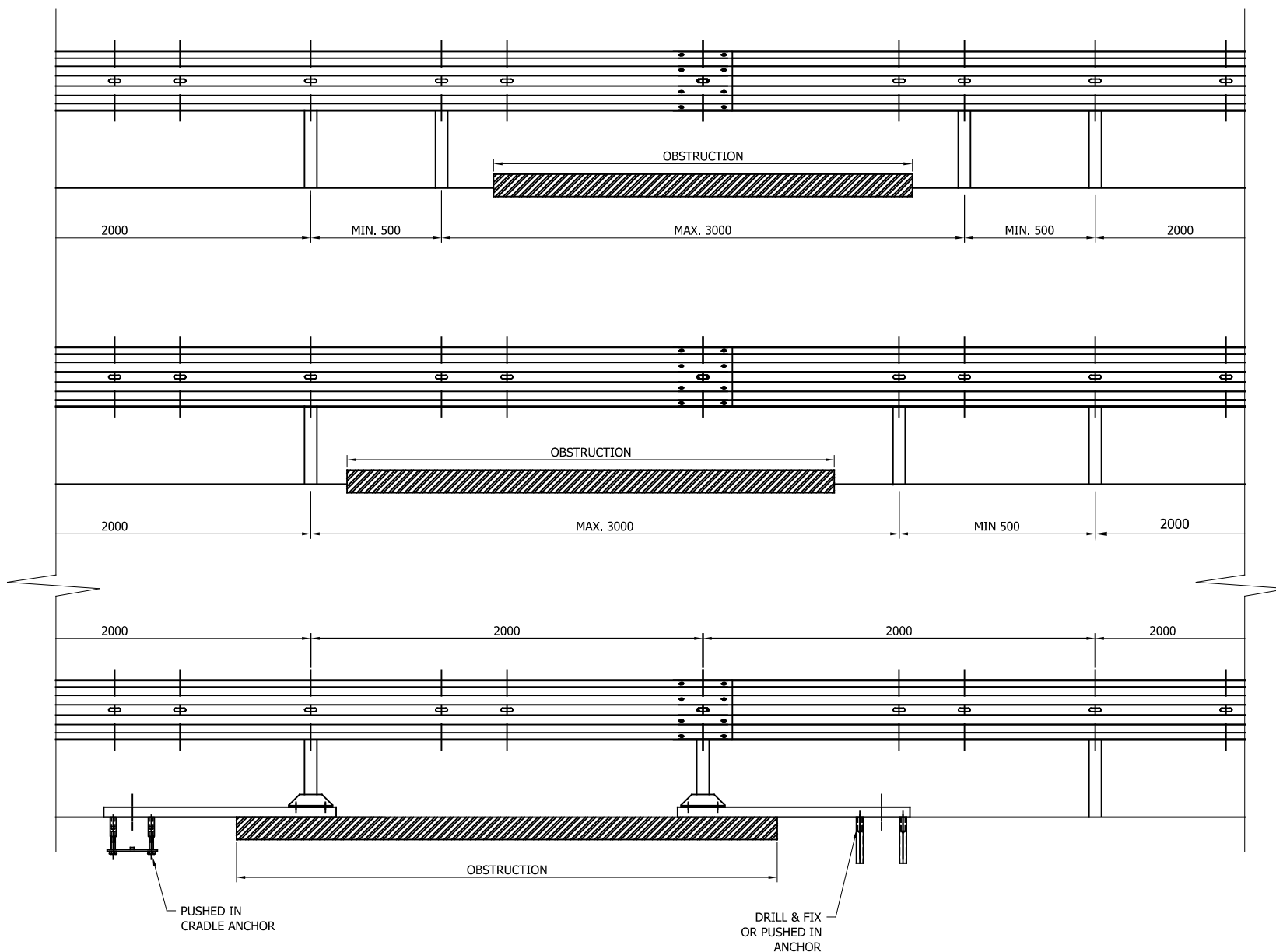

- GENERAL NOTES:
1. IF THE SITE CONDITIONS DO NOT ALLOW A POST TO BE INSTALLED ON THE SYSTEM PITCH DEVIATIONS CAN BE APPLIED. THE OBSTRUCTED POST CAN BE LEFT OUT AND EXTRA POSTS INSTALLED TO SPAN THE OBSTRUCTION. THE NEW POST SPACING MUST NOT EXCEED 3000mm AND MUST NOT BE LESS THAN 500mm. ALTHOUGH IT WOULD BE BENEFICIAL TO USE THE HOLES ALREADY IN THE BEAM IT IS ACCEPTABLE TO DRILL NEW HOLES IN THE DESIRED POSITIONS AND TREAT WITH ZINC RICH PAINT.
 2. OFFSET POSTS SHOWN ON DRAWING H1W4-GA-00 CAN BE USED.

| 05 | 21/05/24 | BEAM SLOT DETAILS UPDATED | H.B |
|------|----------|-----------------------------------|---------|
| 04 | 13/05/22 | SURFACE MOUNTED POST BASE CHANGED | A.D |
| 03 | 23/07/21 | SURFACE MOUNTED POST DETAIL ADDED | A.D |
| 02 | 12/02/19 | TITLEBLOCK REVISED | H.B |
| 01 | 10/03/17 | NOTES REVISED | L.L |
| 00 | 02/02/17 | NEW DRAWING | L.L |
| REVn | DATE | DETAILS | INITIAL |

MegaRail em H1 W4 (VI 4)

N2.W2 VEHICLE RESTRAINT SYSTEM
DEVIATION SETTING OUT
ARRANGEMENT

SAFEROAD

CONCORD HOUSE,
BESSEMER WAY, SCUNTHORPE,
NORTH LINCOLNSHIRE, DN15 8XE
t: 01724 289119
e: john.cudlipp@saferoad.co.uk