

SR027 - "B" PROFILE BEAM 4.3m x 2.5mm THK

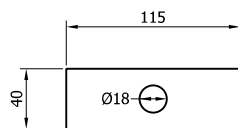

SR151 - WASHER PLATE 115
x 40 x 6 DIA.18

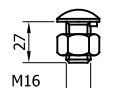

SR200 - SETSCREW 4.6
LIP M16x27 c/w NUT

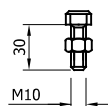

SR206 - SETSCREW
8.8 M10x30 c/w NUT

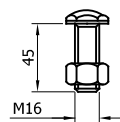

SR201 - SETSCREW 8.8
M16x45 c/w NUT



SR300 - M16
WASHER 18Ø HOLE



SR301 - M10
WASHER 11Ø HOLE

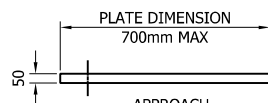

APPROACH
OFFSET POST

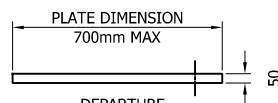

DEPARTURE
OFFSET POST

CAN BE FIXED WITH
CAST IN ANCHORS, DRILL
AND FIX ANCHORS OR
PUSHED IN ANCHORS
AT 180x180 CENTERS

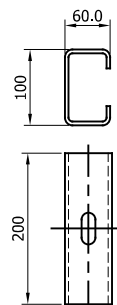
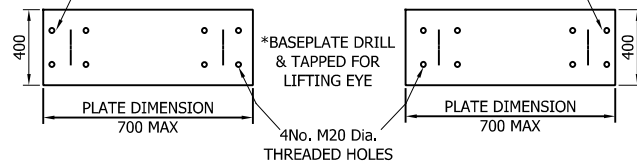

SR226 - POST
SPACER

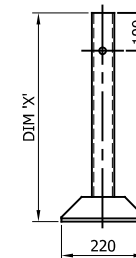
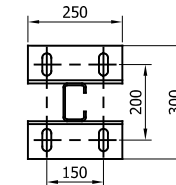
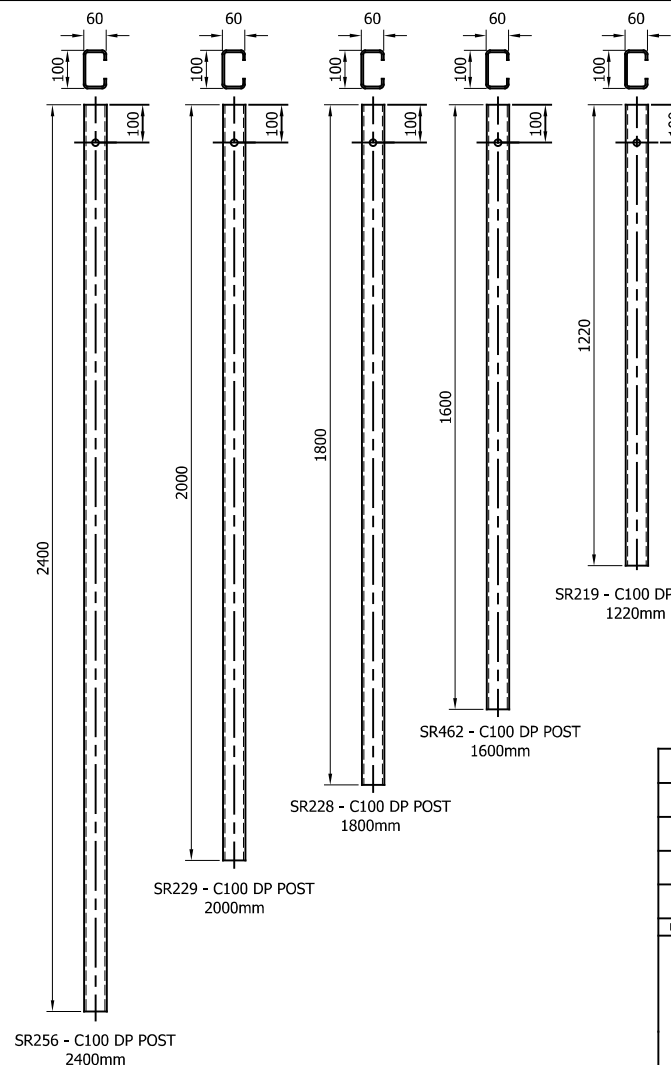

SR463 - SURFACE
MOUNTED C100 DP
POST

04	16/07/24	DRAWING UPDATED	H.B
03	29/03/23	MATERIAL GRADE ADDED	H.B
02	04/10/22	DETAILS AMENDED	H.B
01	01/11/21	REVISED TO 'B' PROFILE	H.B
00	23/02/21	DRAWING CREATED	H.B
REVn	DATE	DETAILS	INITIAL

MEGARAIL dp H2 W4

MEGARAIL DP H2W4 COMPONENTS
SCHEMATIC



CONCORD HOUSE,
BESSEMER WAY, SCUNTHORPE,
NORTH LINCOLNSHIRE, DN15 8XE
t: 01724 289119
FOR TECHNICAL ASSISTANCE CONTACT
john.cudlipp@saferoad.co.uk

DRAWING NUMBER:

MR-H2W4dp-GA-00

REVn:

04

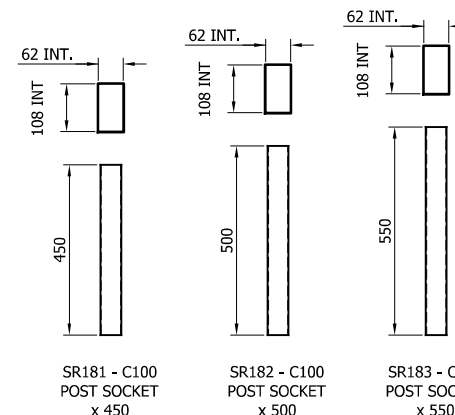

SR181 - C100
POST SOCKET
x 450

SR182 - C100
POST SOCKET
x 500

SR183 - C100
POST SOCKET
x 550

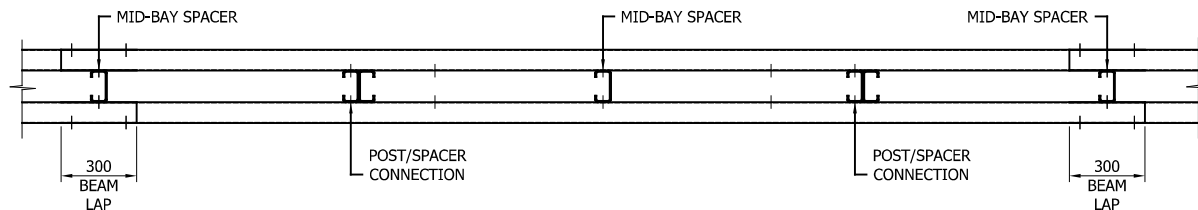
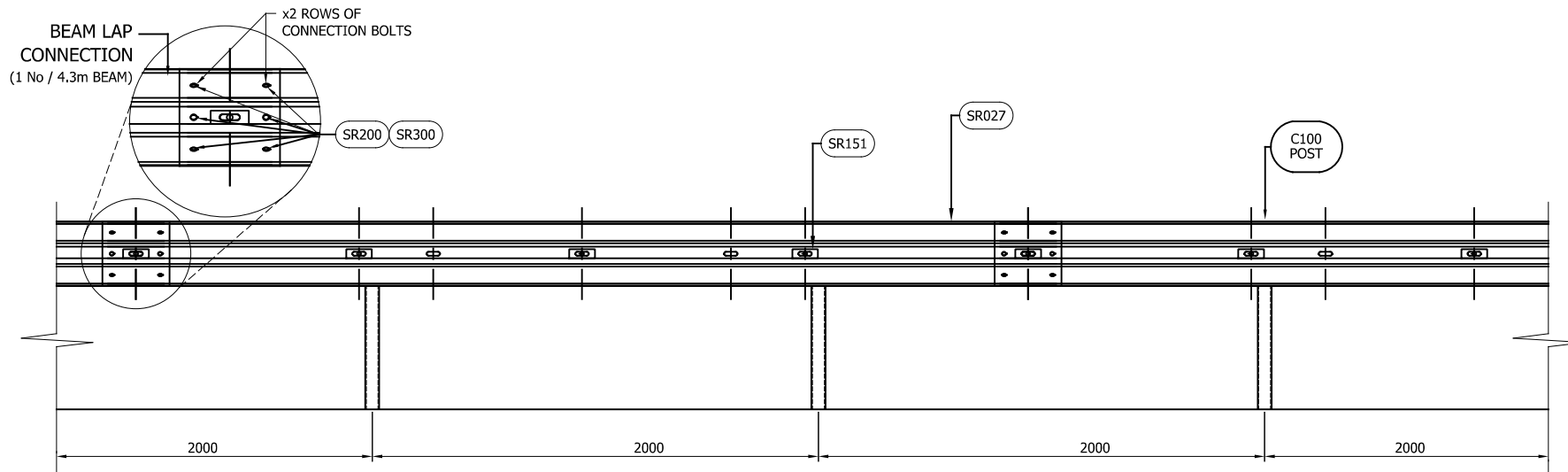

MID-BAY SPACERS TO BE
IN OPPOSITE ORIENTATION
TO POSTS

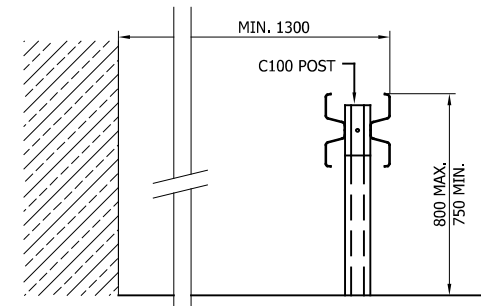

GENERAL NOTES:

1. POSTS ARE TO BE INSTALLED WITH THE CLOSED FACE OF THE CHANNEL TOWARDS THE ON-COMING TRAFFIC.
2. FOR OPTIONS ON POST FOUNDATIONS REFER TO DRAWING NUMBER MR-GA-020
3. FOR DEVIATIONS IN SYSTEM POST PITCH REFER TO DRAWING MR-H2W4dp-GA-40.
4. WHEN TYING INTO ADJACENT VRS ONLY ONE WORKING WIDTH DIFFERENCE IS PERMITTED, SEE SYSTEM PROGRESSION DETAILS.
5. WHERE A KERB IS PRESENT THE MAXIMUM KERB HEIGHT IS 100mm. SHOULD THE KERB BE HIGHER THAN 100mm AND THE FENCE IS SETBACK LESS THAN 250mm FROM THE FACE OF THE KERB, THE SYSTEM HEIGHT IS MEASURED FROM THE CARRIAGEWAY. IF THE SETBACK IS MORE THAN 250mm FROM THE FACE OF KERB THE SYSTEM HEIGHT IS MEASURED FROM THE TOP OF THE KERB.
6. FOR MINIMUM LENGTH OF FULL HEIGHT VRS REFER TO SAFEROAD MEGARAIL MANUAL.

TABLE 'A' - SYSTEM COMPONENT SCHEDULE - QUANTITIES / 4.3m BEAM		
SAFEROAD UK PART NUMBER	DESCRIPTION	QUANTITY
SR027	BEAM "B" PROFILE 2.5MM THK	1
SEE TABLE 'B'	C100 DP POST	2
SR226	POST SPACER	4
FOR SCHEDULE OF BOLTED CONNECTIONS REFER TO DRAWING NUMBER MR-H2W4dp-GA-02		

TABLE 'B' - SCHEDULE OF POST REFERENCE NUMBERS AND LENGTHS	
SAFEROAD UK PART NUMBER	POST LENGTH
SR219	1220
SR462	1600
SR228	1800
SR229	2000
SR256	2400

05	16/07/24	DRAWING UPDATED	H.B
04	29/03/23	MINOR DETAIL UPDATES	H.B
03	24/02/23	HEIGHT DETAILS AMENDED	H.B
02	04/10/22	DETAILS AMENDED	H.B
01	01/11/21	HEIGHT AND PROFILE REV'D	H.B
00	23/02/21	DRAWING CREATED	H.B
REV'n	DATE	DETAILS	INITIAL

MEGARAIL dp H2 W4

MEGARAIL DP GENERAL
ARRANGEMENT AND SETTING OUT
DETAILS



CONCORD HOUSE,
BESSEMER WAY, SCUNTHORPE,
NORTH LINCOLNSHIRE, DN15 8XE
t: 01724 289119
FOR TECHNICAL ASSISTANCE CONTACT
john.cudlipp@saferoad.co.uk

DRAWING NUMBER:

MR-H2W4dp-GA-01

REV'n:

05

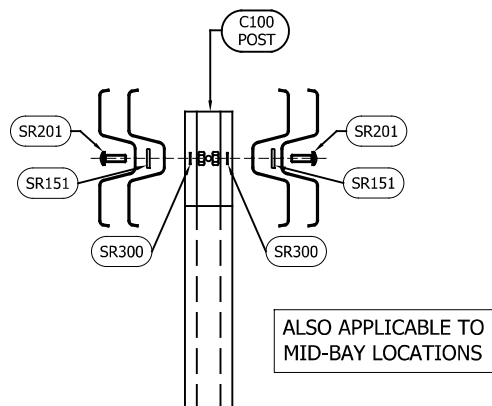

BEAM TO SPACER
CONNECTION

BOLTING COMPONENT SCHEDULE - BEAM TO SPACER CONNECTION		
SAFEROAD UK PART NUMBER	DESCRIPTION	QTY'S P/SPACER
SR201	SETSCREW 8.8 M16 x 45 c/w NUT	2
SR151	WASHER PLATE 115 x 40 x 6 DIA. 18	2
SR300	WASHER M16 18Ø HOLE	2

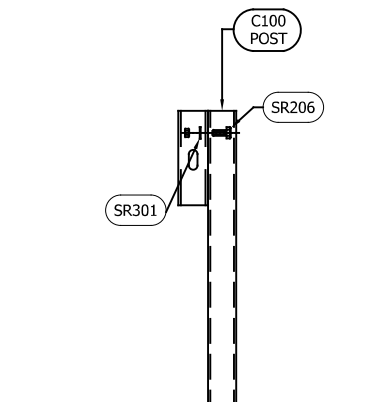

SPACER TO POST
CONNECTION

BOLTING COMPONENT SCHEDULE - SPACER TO POST CONNECTION		
SAFEROAD UK PART NUMBER	DESCRIPTION	QTY'S P/POST
SR201	M10 x 30 8.8 SET SCREW C/W M10 NUT	1
SR301	WASHER M10 11Ø HOLE	2

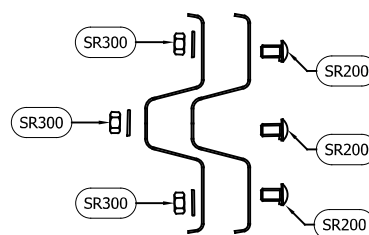

BEAM LAP CONNECTION
ARRANGEMENT
(1No. PER BEAM END)

BOLTING COMPONENT SCHEDULE - QUANTITIES / BEAM		
SAFEROAD UK PART NUMBER	DESCRIPTION	BEAM TO BEAM CONNECTION
SR200	SETSCREW 4.6 LIP M16x27 c/w NUT	6 (+6)
SR300	WASHER M16 18Ø HOLE	6 (+6)

GENERAL NOTES:

- NUMBERS IN THE SCHEDULES SUFFIXED (+) DENOTES THE ADDITIONAL QUANTITY OF COMPONENTS REQUIRED FOR EXTREME ENDS OF INDIVIDUAL RUNS OF BARRIER.

04	16/07/24	DRAWING UPDATED	H,B
03	29/03/23	DETAILS UPDATED	H,B
02	26/09/22	FIXING CODE UPDATE	H,B
01	01/11/21	REVISED TO 'B' PROFILE	H,B
00	23/02/21	DRAWING CREATED	H,B
REVn	DATE	DETAILS	INITIAL

MEGARAIL dp H2 W4

MEGARAIL DP FIXING &
INSTALLATION SCHEMATIC



CONCORD HOUSE,
BESSEMER WAY, SCUNTHORPE,
NORTH LINCOLNSHIRE, DN15 8XE
t: 01724 289119
FOR TECHNICAL ASSISTANCE CONTACT
john.cudlipp@saferoad.co.uk

DRAWING NUMBER:

MR-H2W4dp-GA-02

REVn:

04

- GENERAL NOTES:
1. POSTS ARE TO BE INSTALLED WITH THE CLOSED FACE OF THE CHANNEL TOWARDS THE ON-COMING TRAFFIC.

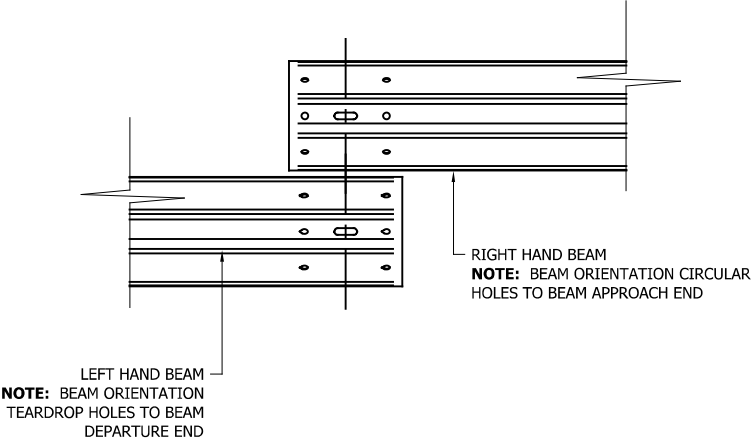

BEAM LAP PRINCIPLES APPLY TO OPPOSITE SIDE OF POST

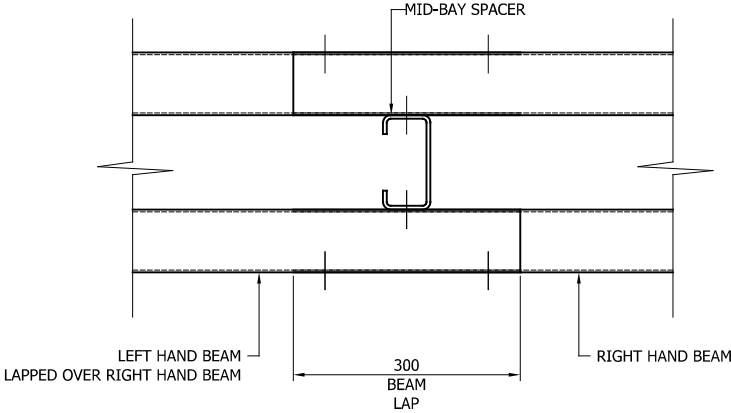

** BEAM REFERENCES i.e. LEFT / RIGHT HAND ARE FOR VERGE INSTALLATIONS; FOR CENTRAL RESERVATION INSTALLATIONS THE REFERENCES ARE REVERSED

REVn	DATE	DETAILS	INITIAL
03	16/07/24	DRAWING UPDATED	H.B
02	29/03/23	MINOR DETAIL UPDATE	H.B
01	01/11/21	REVISED TO 'B' PROFILE	H.B
00	23/02/21	DRAWING CREATED	H.B

MEGARAIL dp H2 W4

MEGARAIL DP BEAM LAPPING
DETAILS



CONCORD HOUSE,
BESSEMER WAY, SCUNTHORPE,
NORTH LINCOLNSHIRE, DN15 8XE
t: 01724 289119
FOR TECHNICAL ASSISTANCE CONTACT
john.cudlipp@saferoad.co.uk

DRAWING NUMBER:	REVn:
MR-H2W4dp-GA-03	03

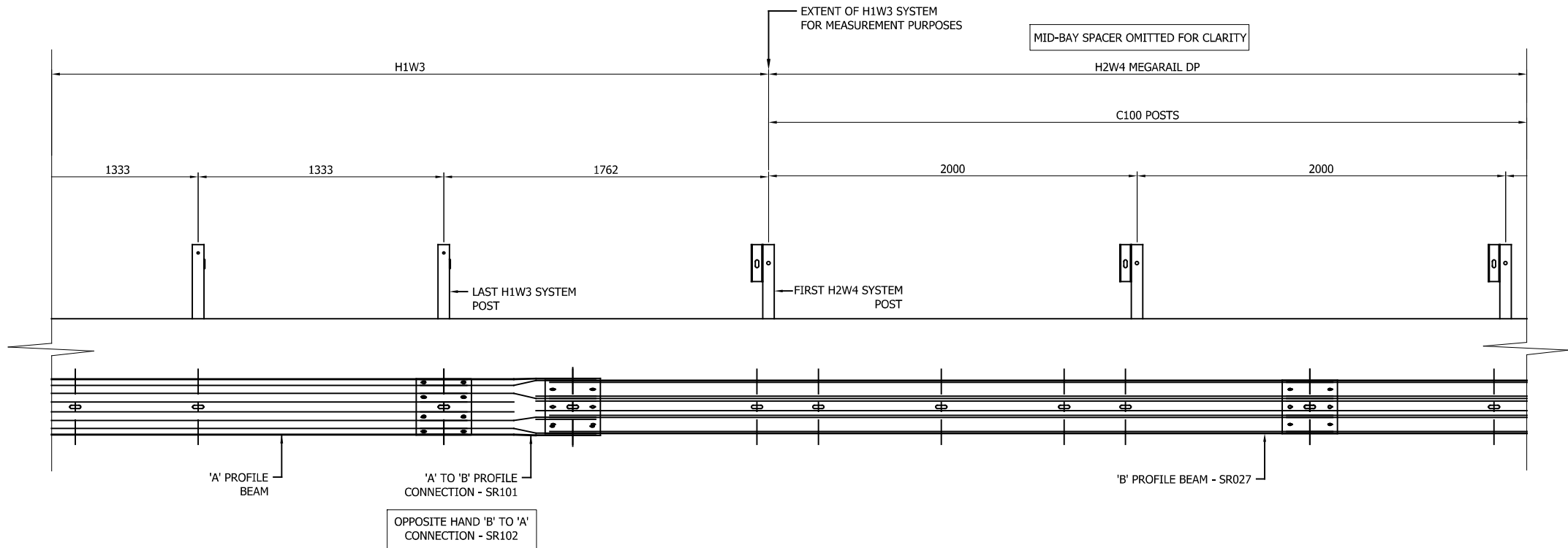

GENERAL NOTES:

1. POSTS ARE TO BE INSTALLED WITH THE CLOSED FACE OF THE CHANNEL TOWARDS THE ON-COMING TRAFFIC.
2. MID-BAY SPACER OMITTED FROM SCHEMATIC FOR CLARITY

** BEAM REFERENCES i.e. LEFT / RIGHT HAND ARE FOR VERGE INSTALLATIONS; FOR CENTRAL RESERVATION INSTALLATIONS THE REFERENCES ARE REVERSED

MEGARAIL dp H2 W4

MEGARAIL DP SYSTEM PROGRESSION
DETAILS



CONCORD HOUSE,
BESSEMER WAY, SCUNTHORPE,
NORTH LINCOLNSHIRE, DN15 8XE
t: 01724 289119
FOR TECHNICAL ASSISTANCE CONTACT
john.cudlipp@saferoad.co.uk

REVn	DATE	DETAILS	INITIAL
03	16/07/24	DRAWING UPDATED	H.B
02	29/03/23	SYSTEM PROGRESSION UPDATE	H.B
01	01/11/21	REVISED TO 'B' PROFILE	H.B
00	23/02/21	DRAWING CREATED	H.B

DRAWING NUMBER:	REVn:
MR-H2W4dp-GA-20	03

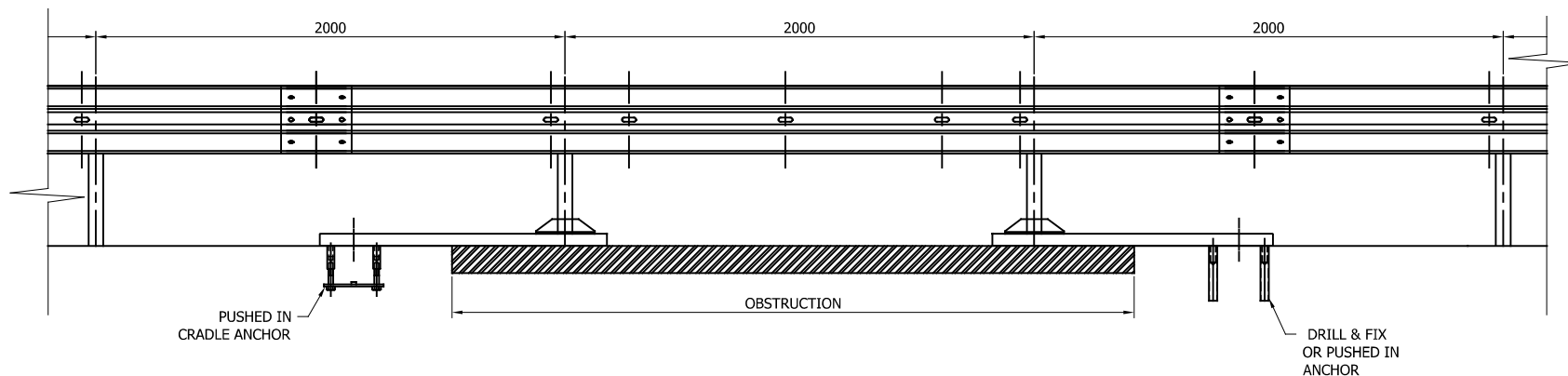
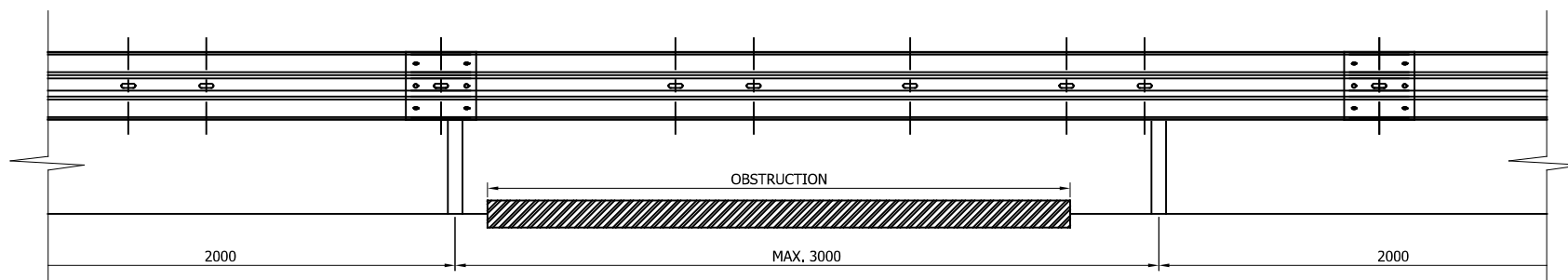
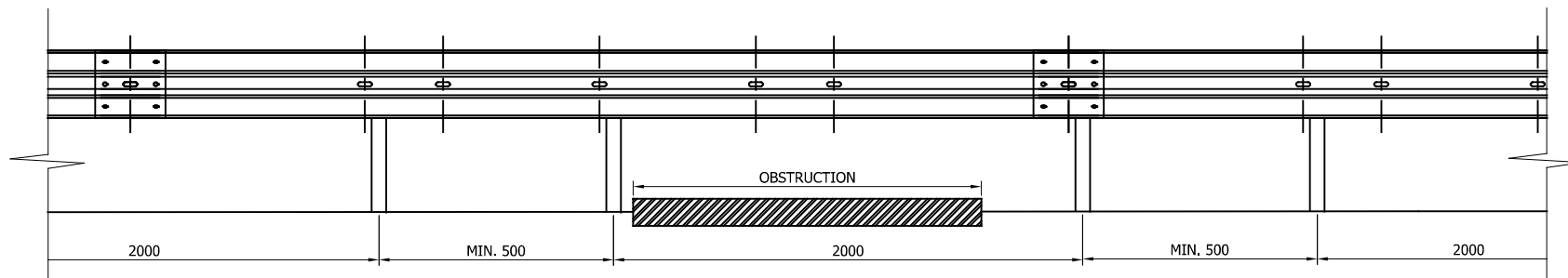

GENERAL NOTES:

1. IF THE SITE CONDITIONS DO NOT ALLOW A POST TO BE INSTALLED ON THE SYSTEM PITCH DEVIATIONS CAN BE APPLIED. THE OBSTRUCTED POST CAN BE LEFT OUT AND EXTRA POSTS INSTALLED TO SPAN THE OBSTRUCTION AS PER THIS DRAWING. ALTHOUGH IT WOULD BE BENEFICIAL TO USE THE HOLES ALREADY IN THE BEAM IT IS ACCEPTABLE TO DRILL NEW HOLES IN THE DESIRED POSITIONS AND TREAT WITH ZINC RICH PAINT.
2. OFFSET POSTS SHOWN ON DRAWING MR-H2W4dp-GA-00 CAN BE USED.

03	16/07/24	DRAWING UPDATED	H.B
02	29/03/23	SURFACE MOUNTED OPTION ADDED	H.B
01	01/11/21	REVISED TO 'B' PROFILE	H.B
00	23/02/21	DRAWING CREATED	H.B
REVn	DATE	DETAILS	INITIAL

MEGARAIL dp H2 W4

MEGARAIL DP PERMISSIBLE
DEVIATION SETTING OUT DETAILS



CONCORD HOUSE,
BESSEMER WAY, SCUNTHORPE,
NORTH LINCOLNSHIRE, DN15 8XE
t: 01724 289119
FOR TECHNICAL ASSISTANCE CONTACT
john.cudlipp@saferoad.co.uk

DRAWING NUMBER:	REVn:
MR-H2W4dp-GA-40	03