

SR022 - BEAM
2.4MM BEAM ONLY - HAS ID HOLES AT TEAR DROP ENDS OF BEAM

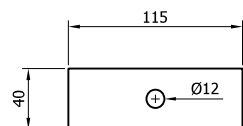

SR152 - WASHER PLATE 115
x 40 x 5 DIA.12

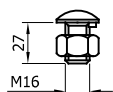

SR200 - SETSCREW 4.6
LIP M16x27 c/w NUT

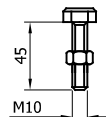

SR124 - SETSCREW
M10x45 c/w NUT

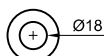

SR300 - M16
WASHER 18Ø HOLE



SR301 - M10
WASHER 11Ø HOLE

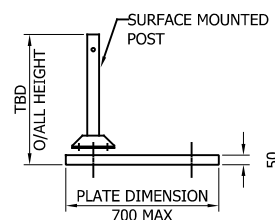
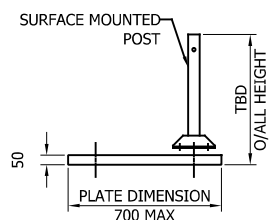

CAN BE FIXED WITH
CAST IN ANCHORS, DRILL
AND FIX ANCHORS OR
PUSHED IN ANCHORS
AT 180x180 CENTERS

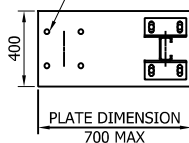

BASEPLATE DRILL &
TAPPED FOR LIFTING EYE

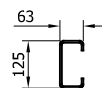
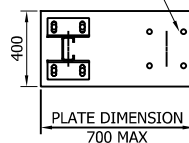

SR040 - TYPE 'A' POST
"C" 125 2400mm

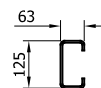

SR035 - TYPE 'A' POST
"C" 125 1800mm

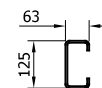

SR034 - TYPE 'A' POST
"C" 125 1100mm

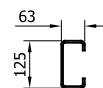

SR036 - TYPE 'A' POST
"C" 125 2000mm

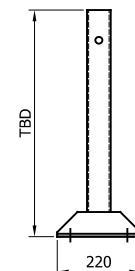
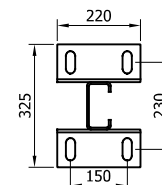

SURFACE MOUNTED -
TYPE 'A' C-125 POST

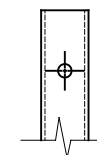
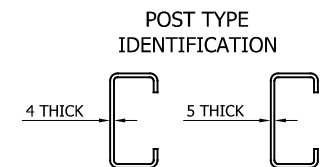

TYPE 'A'

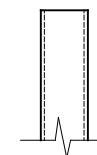

TYPE 'B'

07	21/05/24	BEAM SLOT DETAILS UPDATED	H.B
06	13/05/22	SURFACE MOUNTED POST BASE CHANGED	A.D
05	27/05/21	DETAILS REVISED	M.T
04	12/02/19	TITLEBLOCK REVISED	H.B
03	10/03/17	DETAILS REVISED	L.L
02	01/02/17	DETAILS REVISED	L.L
1.2	20/05/15	DETAILS REVISED	M.T
REVn	DATE	DETAILS	INITIAL

MegaRail em H1 W4 (VI 4)

H1.W4 VEHICLE RESTRAINT SYSTEM
COMPONENTS SCHEMATIC



CONCORD HOUSE,
BESSEMER WAY, SCUNTHORPE,
NORTH LINCOLNSHIRE, DN15 8XE
t: 01724 289119
e: john.cudlipp@saferoad.co.uk

DRAWING NUMBER:

H1W4-GA-00

REVn:

07



SR100 - A21
REINFORCING
RING

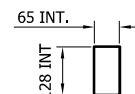

SR080 - C-125
POST SOCKET
x 470

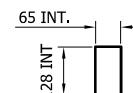

SR081 - C-125
POST SOCKET
x 520

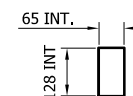

SR083 - C-125
POST SOCKET
x 570

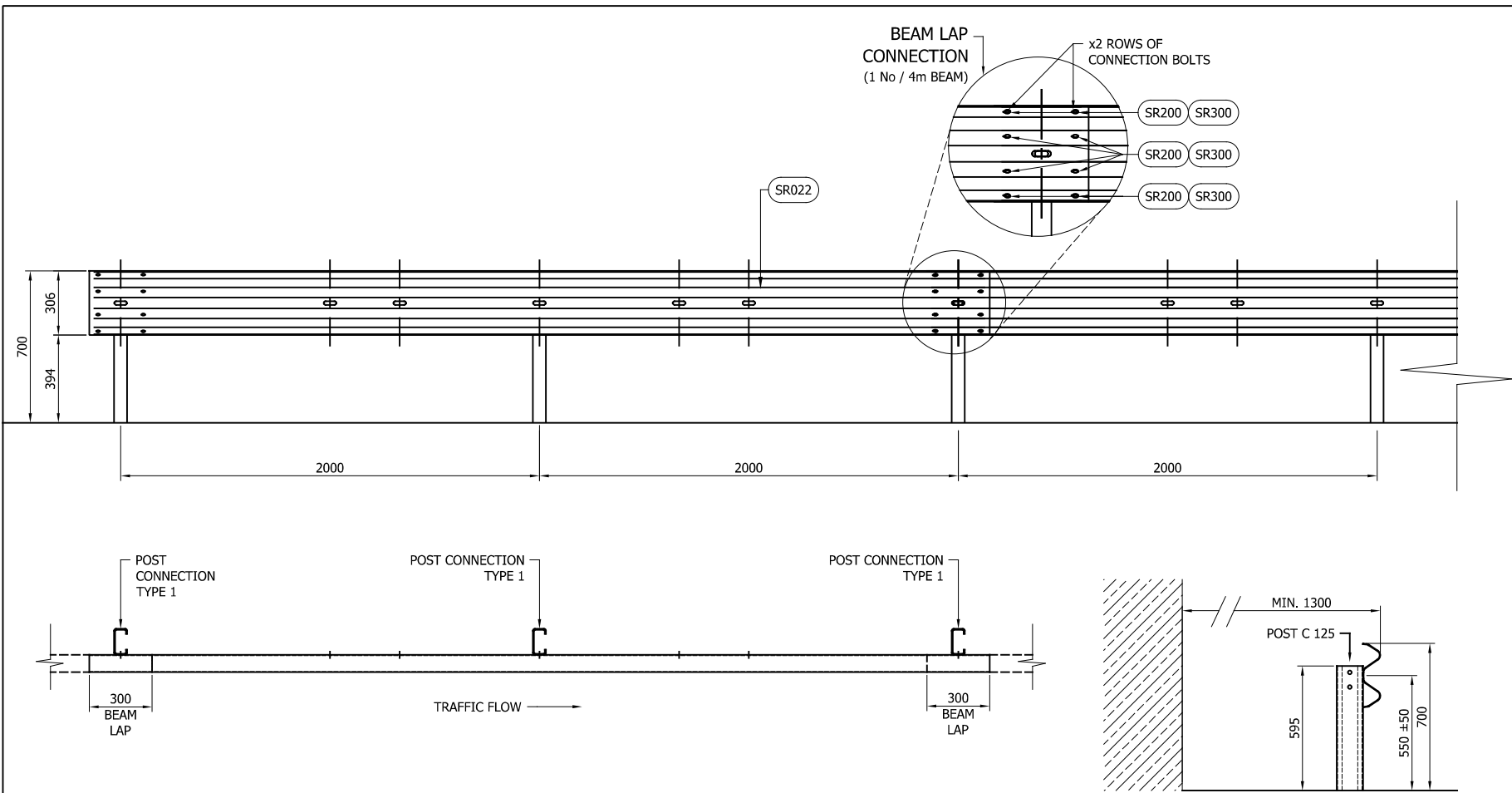

- GENERAL NOTES:
1. POSTS ARE TO BE INSTALLED WITH THE CLOSED FACE OF THE CHANNEL TOWARDS THE ON-COMING TRAFFIC.
 2. FOR OPTIONS ON POST FOUNDATIONS REFER TO DRAWING NUMBER MR-GA-020
 3. FOR DEVIATIONS IN SYSTEM POST PITCH REFER TO DRAWING H1W4-GA-40
 4. WHEN TYING INTO ADJACENT VRS ONLY ONE WORKING WIDTH DIFFERENCE IS PERMITTED. SEE SYSTEM PROGRESSION DETAILS
 5. WHERE A KERB IS PRESENT THE MAXIMUM KERB HEIGHT IS 100mm.
 6. FOR MINIMUM LENGTH OF FULL HEIGHT VRS REFER TO SAFEROAD MEGARAIL MANUAL.

TABLE 'A' - SYSTEM COMPONENT SCHEDULE - QUANTITIES / 4m BEAM		
SAFEROAD UK PART NUMBER	DESCRIPTION	QUANTITY
SR022	BEAM "A" PROFILE	1
SEE TABLE 'B'	POST "C" 125	2
FOR SCHEDULE OF BOLTED CONNECTIONS REFER TO DRAWING NUMBER H1W4-GA-02		

TABLE 'B' - SCHEDULE OF POST REFERENCE NUMBERS AND LENGTHS	
SAFEROAD UK PART NUMBER	POST LENGTH
SR034	1100
SR035	1800
SR036	2000
SR040	2400

05	21/05/24	BEAM SLOT DETAILS UPDATED	H.B
04	12/02/19	TITLEBLOCK REVISED	H.B
03	12/02/17	DETAILS REVISED	L.L
02	01/02/17	DETAILS REVISED	L.L
1.2	20/05/15	DETAILS REVISED	M.T
REVn	DATE	DETAILS	INITIAL

MegaRail em H1 W4 (VI 4)

H1.W4 VEHICLE RESTRAINT SYSTEM
ASSEMBLY AND SETTING OUT
ARRANGEMENT



CONCORD HOUSE,
BESSEMER WAY, SCUNTHORPE,
NORTH LINCOLNSHIRE, DN15 8XE
t: 01724 289119
e: john.cudlipp@saferoad.co.uk

DRAWING NUMBER:	REVn:
H1W4-GA-01	05

- GENERAL NOTES:
1. NUMBERS IN THE SCHEDULES SUFFIXED (+) DENOTES THE ADDITIONAL QUANTITY OF COMPONENTS REQUIRED FOR EXTREME ENDS OF INDIVIDUAL RUNS OF BARRIER.

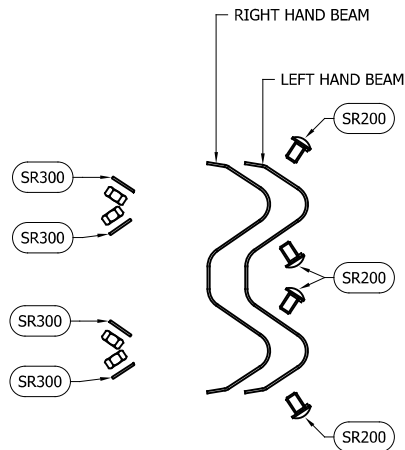

BEAM TO BEAM CONNECTION
ARRANGEMENT
(x2 LOCATIONS / BEAM END)

BOLTING COMPONENT SCHEDULE - QUANTITIES / BEAM		
SAFEROAD UK PART NUMBER	DESCRIPTION	BEAM TO BEAM CONNECTION
SR200	SETSCREW 4.6 LIP M16x27 c/w NUT	8 (+8)
SR300	WASHER M16 18Ø HOLE	8 (+8)

** BEAM REFERENCES i.e. LEFT / RIGHT HAND ARE FOR VERGE INSTALLATIONS; FOR CENTRAL RESERVATION INSTALLATIONS THE REFERENCES ARE REVERSED

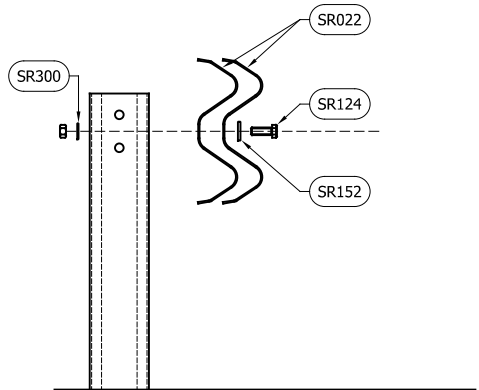

BEAM TO POST
CONNECTION TYPE 1

BOLTING COMPONENT SCHEDULE - QUANTITIES / POST		
SAFEROAD UK PART NUMBER	DESCRIPTION	TYPE 1 CONNECTION
SR124	SETSCREW 8.8 M10 x 45 c/w NUT	2
SR152	WASHER PLATE 115 x 40 x 5 DIA. 12	2
SR301	WASHER M10 12Ø HOLE	2

MegaRail em H1 W4 (VI 4)

H1.W4 VEHICLE RESTRAINT SYSTEM
BOLTING ARRANGEMENTS



CONCORD HOUSE,
BESSEMER WAY, SCUNTHORPE,
NORTH LINCOLNSHIRE, DN15 8XE
t: 01724 289119
e: john.cudlipp@saferoad.co.uk

DRAWING NUMBER:	REVn:
H1W4-GA-02	04

- GENERAL NOTES:
1. POSTS ARE TO BE INSTALLED WITH THE CLOSED FACE OF THE CHANNEL TOWARDS THE ON-COMING TRAFFIC.

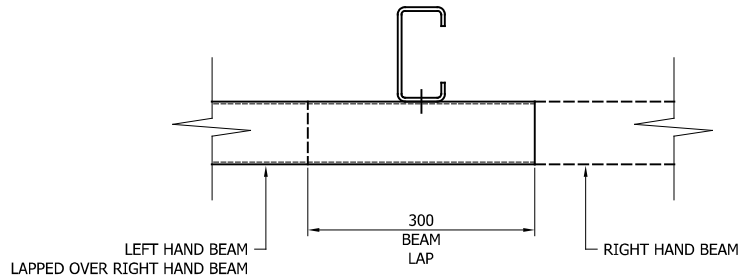
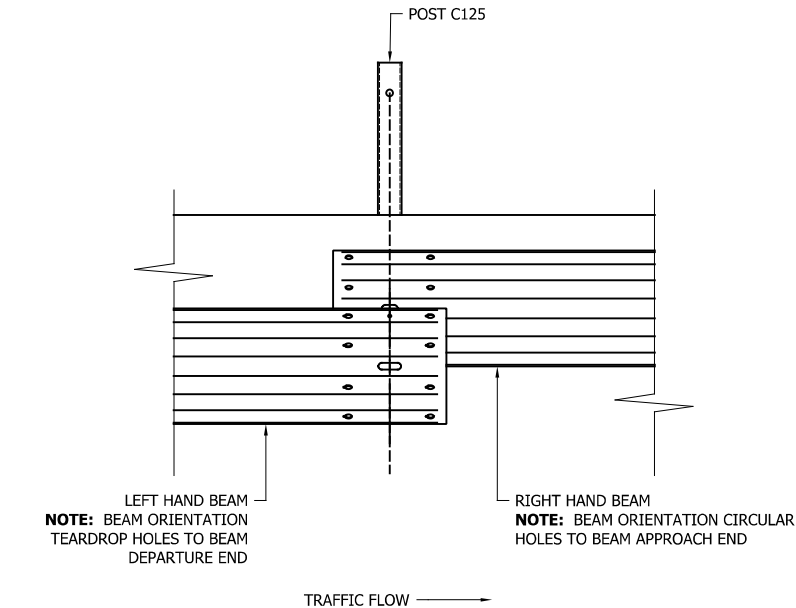

** BEAM REFERENCES i.e. LEFT / RIGHT HAND ARE FOR VERGE
INSTALLATIONS; FOR CENTRAL RESERVATION INSTALLATIONS THE
REFERENCES ARE REVERSED

05	21/05/24	DRAWING UPDATED	H.B
04	12/02/19	TITLEBLOCK REVISED	H.B
03	01/02/17	DETAILS REVISED	L.L
02	01/02/17	DETAILS REVISED	L.L
1.2	20/05/15	DETAILS REVISED	M.T
REVn	DATE	DETAILS	INITIAL

MegaRail em H1 W4 (VI 4)

H1.W4 VEHICLE RESTRAINT SYSTEM.
BEAM LAPPING DETAIL FOR W4
MegaRail em SYSTEM



CONCORD HOUSE,
BESSEMER WAY, SCUNTHORPE,
NORTH LINCOLNSHIRE, DN15 8XE
t: 01724 289119
e: john.cudlipp@saferoad.co.uk

DRAWING NUMBER:	REVn:
H1W4-GA-03	05

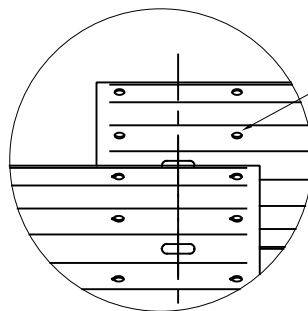
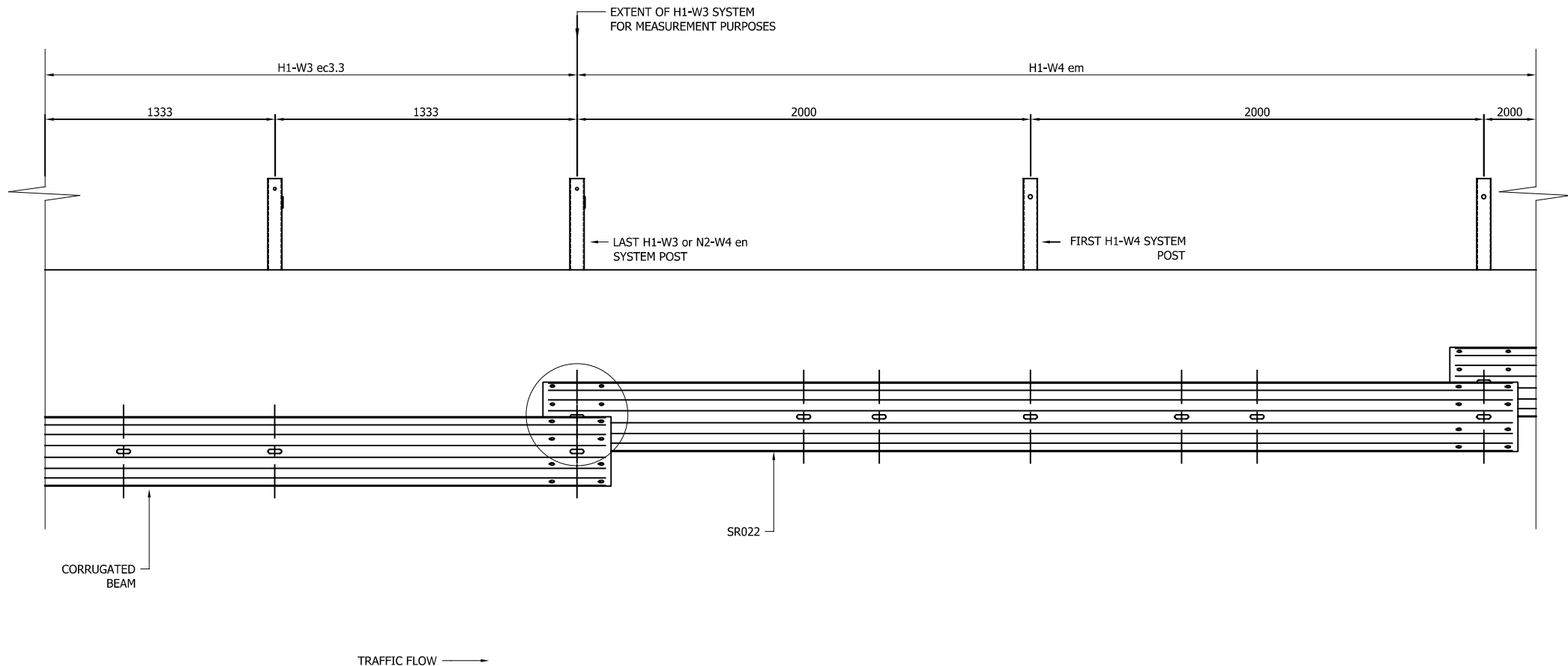

NOTE: BEAM ORIENTATION CIRCULAR HOLES TO BEAM APPROACH END

**** BEAM REFERENCES** i.e. LEFT / RIGHT HAND ARE FOR VERGE INSTALLATIONS; FOR CENTRAL RESERVATION INSTALLATIONS THE REFERENCES ARE REVERSED

GENERAL NOTES:

1. POSTS ARE TO BE INSTALLED WITH THE CLOSED FACE OF THE CHANNEL TOWARDS THE ON-COMING TRAFFIC.

MegaRail em H1 W4 (VI 4)

H1.W4 VEHICLE RESTRAINT SYSTEM
ASSEMBLY & SETTING OUT
ARRANGEMENT



CONCORD HOUSE,
BESSEMER WAY, SCUNTHORPE,
NORTH LINCOLNSHIRE, DN15 8XE
t: 01724 289119
e: john.cudlipp@saferoad.co.uk

REVn	DATE	DETAILS	INITIAL
03	21/05/24	BEAM SLOT DETAILS UPDATED	H.B
02	12/02/19	TITLEBLOCK REVISED	H.B
01	10/03/17	POST DETAILS REVISED	L.L
00	02/02/17	NEW DRAWING	L.L

DRAWING NUMBER:

H1W4-GA-20

REVn:

03

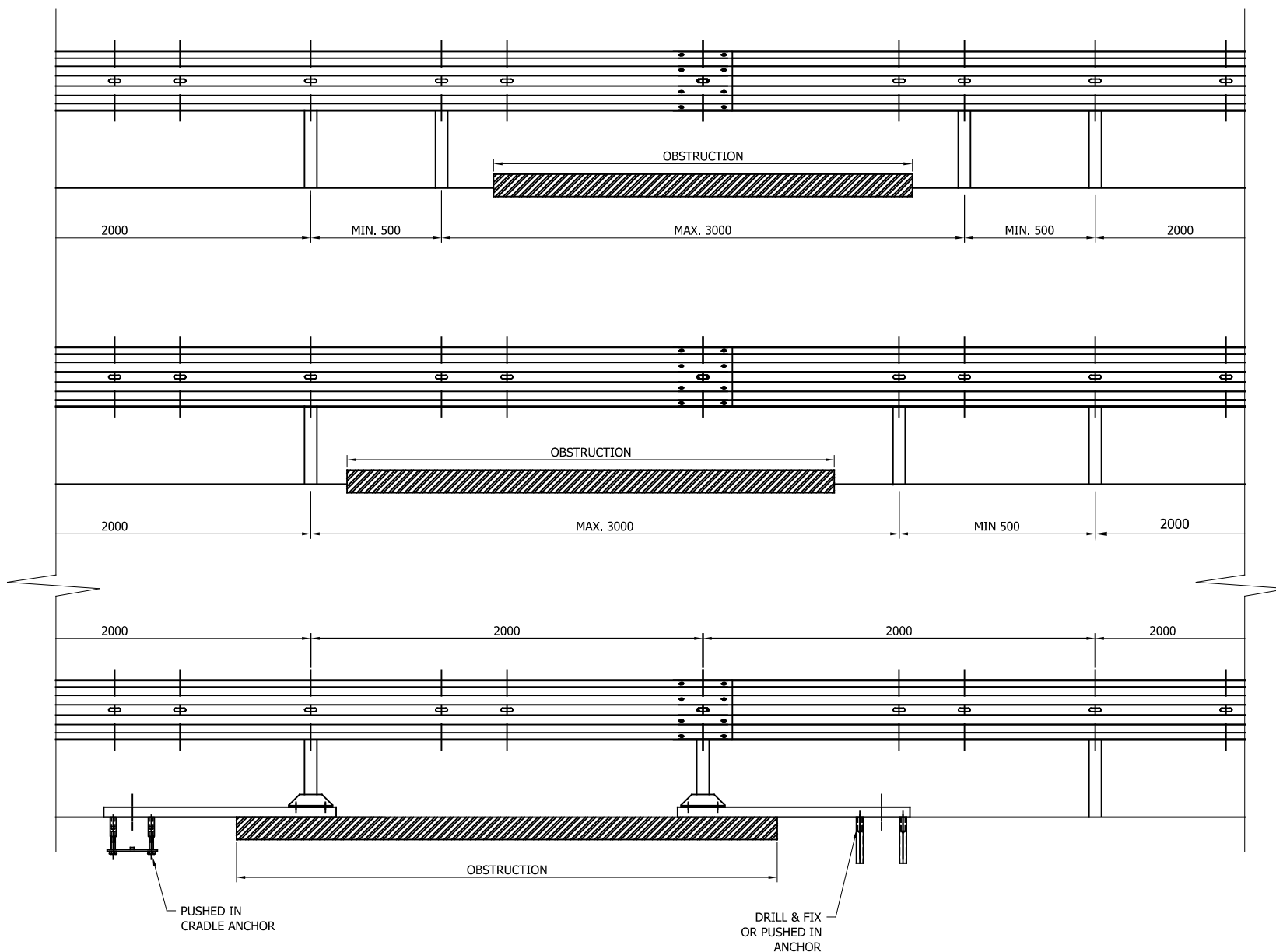

- GENERAL NOTES:
1. IF THE SITE CONDITIONS DO NOT ALLOW A POST TO BE INSTALLED ON THE SYSTEM PITCH DEVIATIONS CAN BE APPLIED. THE OBSTRUCTED POST CAN BE LEFT OUT AND EXTRA POSTS INSTALLED TO SPAN THE OBSTRUCTION. THE NEW POST SPACING MUST NOT EXCEED 3000mm AND MUST NOT BE LESS THAN 500mm. ALTHOUGH IT WOULD BE BENEFICIAL TO USE THE HOLES ALREADY IN THE BEAM IT IS ACCEPTABLE TO DRILL NEW HOLES IN THE DESIRED POSITIONS AND TREAT WITH ZINC RICH PAINT.
 2. OFFSET POSTS SHOWN ON DRAWING H1W4-GA-00 CAN BE USED.

05	21/05/24	BEAM SLOT DETAILS UPDATED	H.B
04	13/05/22	SURFACE MOUNTED POST BASE CHANGED	A.D
03	23/07/21	SURFACE MOUNTED POST DETAIL ADDED	A.D
02	12/02/19	TITLEBLOCK REVISED	H.B
01	10/03/17	NOTES REVISED	L.L
00	02/02/17	NEW DRAWING	L.L
REVn	DATE	DETAILS	INITIAL

MegaRail em

H1 W4 (VI 4)

N2.W2 VEHICLE RESTRAINT SYSTEM
DEVIATION SETTING OUT
ARRANGEMENT

CONCORD HOUSE,
BESSEMER WAY, SCUNTHORPE,
NORTH LINCOLNSHIRE, DN15 8XE
t: 01724 289119
e: john.cudlipp@saferoad.co.uk

DRAWING NUMBER:

H1W4-GA-40

REVn:

05