

SR022 - 2.4mm BEAM ONLY  
HAS I.D HOLE AT TEARDROP END OF BEAM

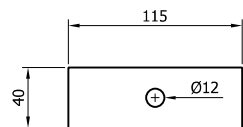

SR152 - WASHER PLATE 115  
x 40 x 5 DIA.12

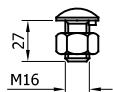

SR200 - SETSCREW 4.6  
LIP M16x27 c/w NUT

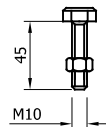

SR124 - SETSCREW  
M10x45 c/w NUT

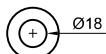

SR300 - M16  
WASHER 18Ø HOLE



SR301 - M10  
WASHER 11Ø HOLE

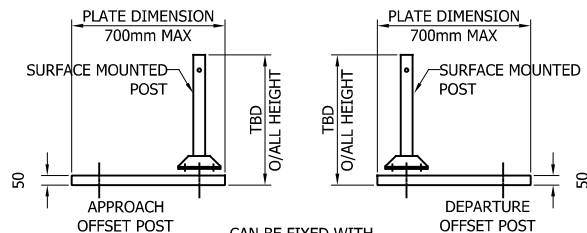

CAN BE FIXED WITH  
CAST IN ANCHORS, DRILL  
AND FIX ANCHORS OR  
PUSHED IN ANCHORS  
AT 180x180 CENTERS

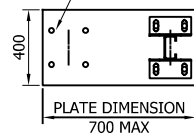

\*BASEPLATE DRILL  
& TAPPED FOR  
LIFTING EYE

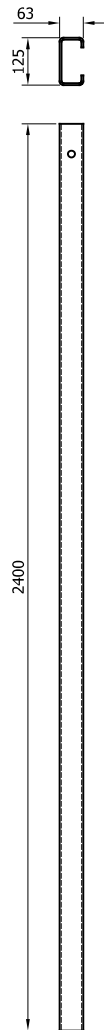
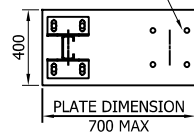

SR052 - TYPE 'A' POST  
"C" 125 2000mm

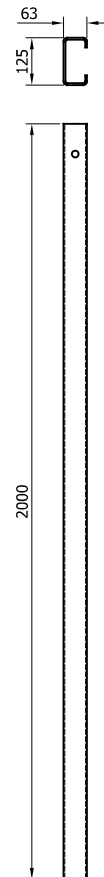

SR035 - TYPE 'A' POST  
"C" 125 1800mm

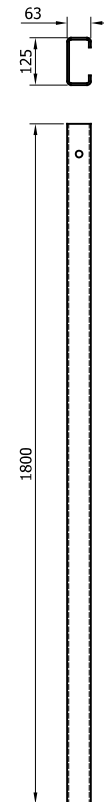

SR034 - TYPE 'A' POST  
"C" 125 1100mm

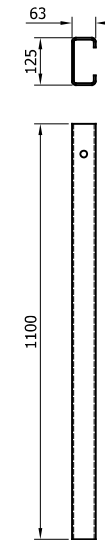

SURFACE MOUNTED -  
TYPE 'A' C-125 POST

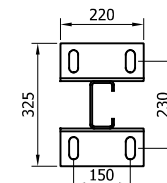

## POST TYPE IDENTIFICATION

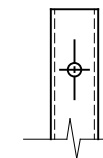
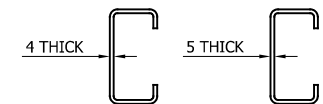

TYPE 'A'

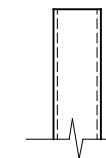

TYPE 'B'

09	21/05/24	BEAM SLOTS REVISED	H.B
08	15/12/22	POST CODES REVISED	H.B
07	27/06/22	NOTE ADDED TO BEAM	A.D
06	13/05/22	SURFACE MOUNTED POST BASE CHANGED	A.D
05	27/05/21	DETAILS REVISED	M.T
04	12/02/19	TITLEBLOCK REVISED	H.B
03	10/03/17	OFFSET POST REVISED	L.L
02	30/01/17	DETAILS REVISED	L.L
1.0	20/05/15	DETAILS REVISED	L.L
REVn	DATE	DETAILS	INITIAL

## MegaRail en N2 W4

N2.W4 VEHICLE RESTRAINT SYSTEM  
COMPONENTS SCHEMATIC



CONCORD HOUSE,  
BESSEMER WAY, SCUNTHORPE,  
NORTH LINCOLNSHIRE, DN15 8XE  
t: 01724 289119  
FOR TECHNICAL ASSISTANCE CONTACT  
john.cudlipp@saferoad.co.uk

DRAWING NUMBER:	REVn:
N2W4en-GA-00	09

SR064 - TYPE 'A' POST  
"C" 125 2400mm



SR100 - A21  
REINFORCING  
RING

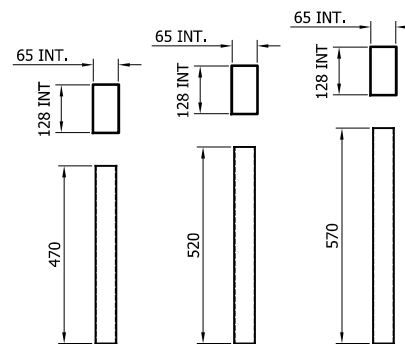

SR080 - C-125  
POST SOCKET  
x 470

SR081 - C-125  
POST SOCKET  
x 520

SR083 - C-125  
POST SOCKET  
x 570

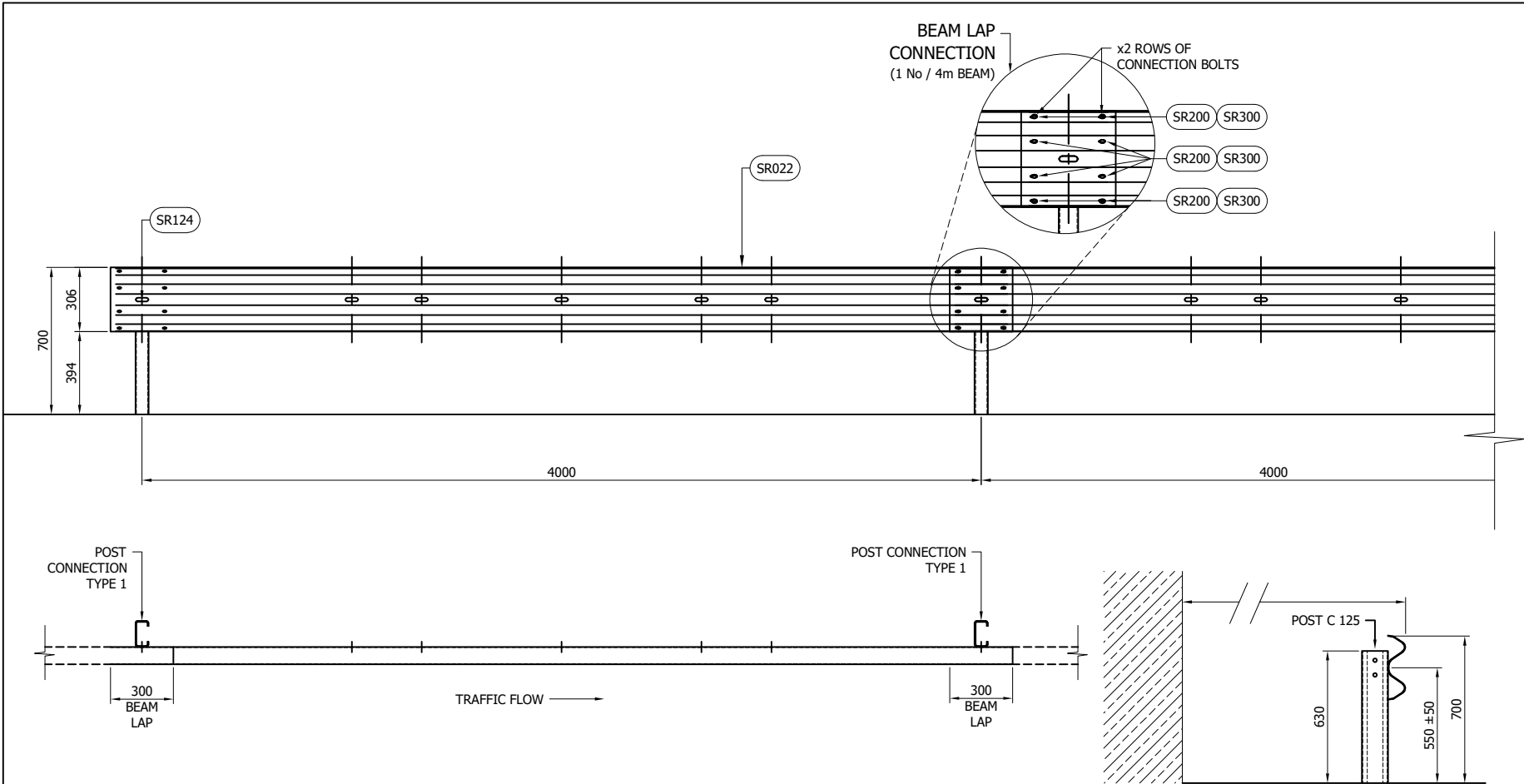

- GENERAL NOTES:
1. POSTS ARE TO BE INSTALLED WITH THE CLOSED FACE OF THE CHANNEL TOWARDS THE ON-COMING TRAFFIC.
  2. FOR OPTIONS ON POST FOUNDATIONS REFER TO DRAWING NUMBER MR-GA-020
  3. FOR DEVIATIONS IN SYSTEM POST PITCH REFER TO DRAWING N2W4en-GA-40.
  4. WHEN TYING INTO ADJACENT VRS ONLY ONE WORKING WIDTH DIFFERENCE IS PERMITTED. SEE SYSTEM PROGRESSION DETAILS.
  5. SEE MR-GA-001 & MR-GA-003 FOR DETAILS OF SYSTEM HEIGHT WITH REFERENCE TO SETBACK & KERB HEIGHT
  6. FOR MINIMUM LENGTH OF FULL HEIGHT VRS REFER TO SAFEROAD MEGARAIL MANUAL.

TABLE 'A' - SYSTEM COMPONENT SCHEDULE - QUANTITIES / 4m BEAM		
SAFEROAD UK PART NUMBER	DESCRIPTION	QUANTITY
SR022	BEAM "A" PROFILE	1
SEE TABLE 'B'	POST "C" 125	1
FOR SCHEDULE OF BOLTED CONNECTIONS REFER TO DRAWING NUMBER N2W4en-GA-02		

TABLE 'B' - SCHEDULE OF POST REFERENCE NUMBERS AND LENGTHS	
SAFEROAD UK PART NUMBER	POST LENGTH
SR034	1100
SR035	1800
SR052	2000
SR064	2400

06	21/05/24	BEAM SLOTS REVISED	H.B
05	15/12/22	POST CODES REVISED	H.B
04	01/04/19	SECTION HEIGHTS REVISED	M.T
03	12/02/19	TITLEBLOCK REVISED	H.B
02	30/01/17	DETAILS REVISED	L.L
1.0	20/05/15	DETAILS REVISED	L.L
REVn	DATE	DETAILS	INITIAL

## MegaRail en N2 W4

N2.W4 VEHICLE RESTRAINT SYSTEM  
ASSEMBLY AND SETTING OUT  
ARRANGEMENT



CONCORD HOUSE,  
BESSEMER WAY, SCUNTHORPE,  
NORTH LINCOLNSHIRE, DN15 8XE  
t: 01724 289119  
FOR TECHNICAL ASSISTANCE CONTACT  
john.cudlipp@saferoad.co.uk

DRAWING NUMBER:  
**N2W4en-GA-01**

REVn:  
**06**

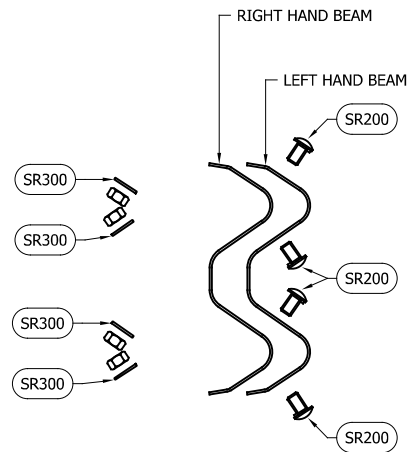

**BEAM TO BEAM CONNECTION  
ARRANGEMENT**  
(x2 LOCATIONS / BEAM END)

BOLTING COMPONENT SCHEDULE - QUANTITIES / BEAM		
SAFEROAD UK PART NUMBER	DESCRIPTION	BEAM TO BEAM CONNECTION
SR200	SETSCREW 4.6 LIP M16x27 c/w NUT	8 (+8)
SR300	WASHER M16 18Ø HOLE	8 (+8)

\*\* BEAM REFERENCES i.e. LEFT / RIGHT HAND ARE FOR VERGE INSTALLATIONS; FOR CENTRAL RESERVATION INSTALLATIONS THE REFERENCES ARE REVERSED

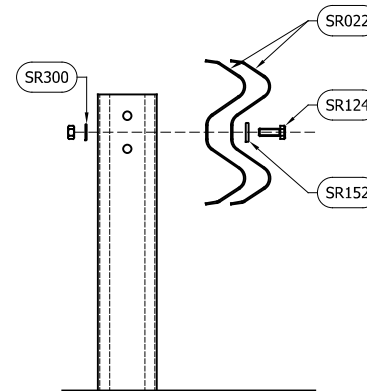

**BEAM TO POST  
CONNECTION TYPE 1**

BOLTING COMPONENT SCHEDULE - QUANTITIES / POST		
SAFEROAD UK PART NUMBER	DESCRIPTION	TYPE 1 CONNECTION
SR124	SETSCREW M10 x 45 c/w NUT	1
SR152	WASHER PLATE 115 x 40 x 5 DIA. 12	1
SR300	WASHER M10 11Ø HOLE	1

**GENERAL NOTES:**

- NUMBERS IN THE SCHEDULES SUFFIXED (+) DENOTES THE ADDITIONAL QUANTITY OF COMPONENTS REQUIRED FOR EXTREME ENDS OF INDIVIDUAL RUNS OF BARRIER.

05	21/05/24	DRAWING UPDATED	H.B
04	30/08/19	FIXING DETAILS REVISED	M.T
03	12/02/19	TITLEBLOCK REVISED	H.B
02	30/01/17	DETAILS REVISED	L.L
1.0	20/05/15	DETAILS REVISED	L.L
REVn	DATE	DETAILS	INITIAL

## MegaRail en N2 W4

N2.W4 VEHICLE RESTRAINT SYSTEM  
BOLTING ARRANGEMENTS



CONCORD HOUSE,  
BESSEMER WAY, SCUNTHORPE,  
NORTH LINCOLNSHIRE, DN15 8XE  
t: 01724 289119  
FOR TECHNICAL ASSISTANCE CONTACT  
john.cudlipp@saferoad.co.uk

DRAWING NUMBER:	REVn:
N2W4en-GA-02	05

- GENERAL NOTES:
1. POSTS ARE TO BE INSTALLED WITH THE CLOSED FACE OF THE CHANNEL TOWARDS THE ON-COMING TRAFFIC.

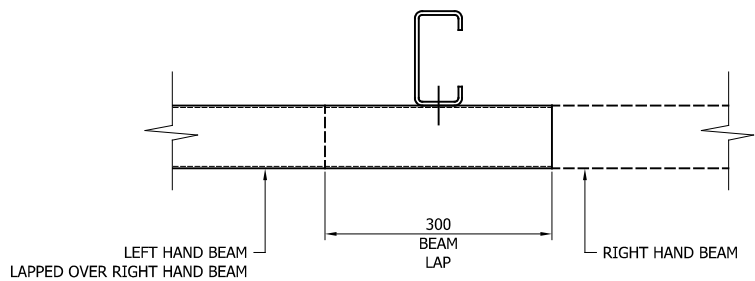
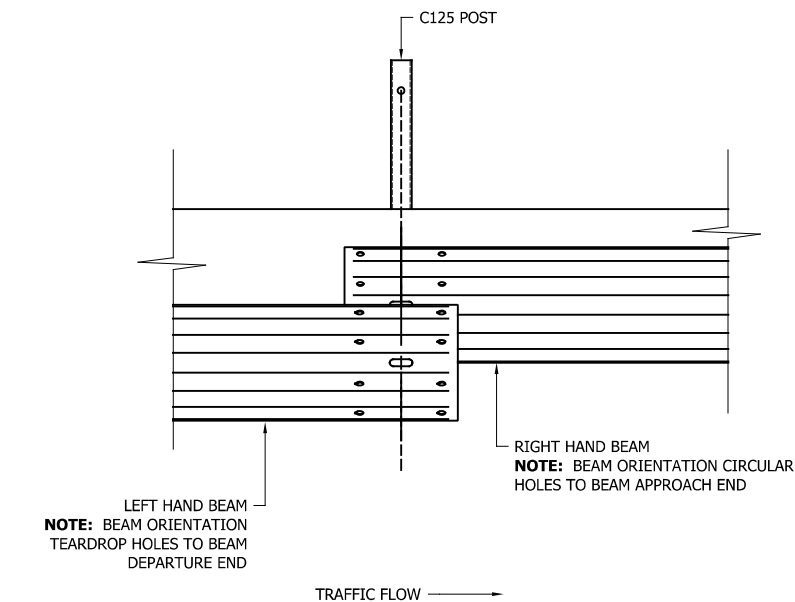

\*\* BEAM REFERENCES i.e. LEFT / RIGHT HAND ARE FOR VERGE INSTALLATIONS; FOR CENTRAL RESERVATION INSTALLATIONS THE REFERENCES ARE REVERSED

REVn	DATE	DETAILS	INITIAL
04	21/05/24	DRAWING UPDATED	H.B
03	12/02/19	TITLEBLOCK REVISED	H.B
02	30/01/17	DETAILS REVISED	L.L
1.0	20/05/15	DETAILS REVISED	L.L

## MegaRail en N2 W4

N2.W4 VEHICLE RESTRAINT SYSTEM.  
BEAM LAPPING DETAIL FOR W4  
MegaRail en SYSTEM



CONCORD HOUSE,  
BESSEMER WAY, SCUNTHORPE,  
NORTH LINCOLNSHIRE, DN15 8XE  
t: 01724 289119  
FOR TECHNICAL ASSISTANCE CONTACT  
john.cudlipp@saferoad.co.uk

DRAWING NUMBER:	REVn:
N2W4en-GA-03	04

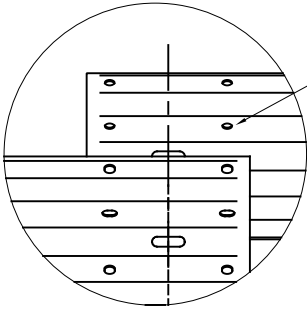
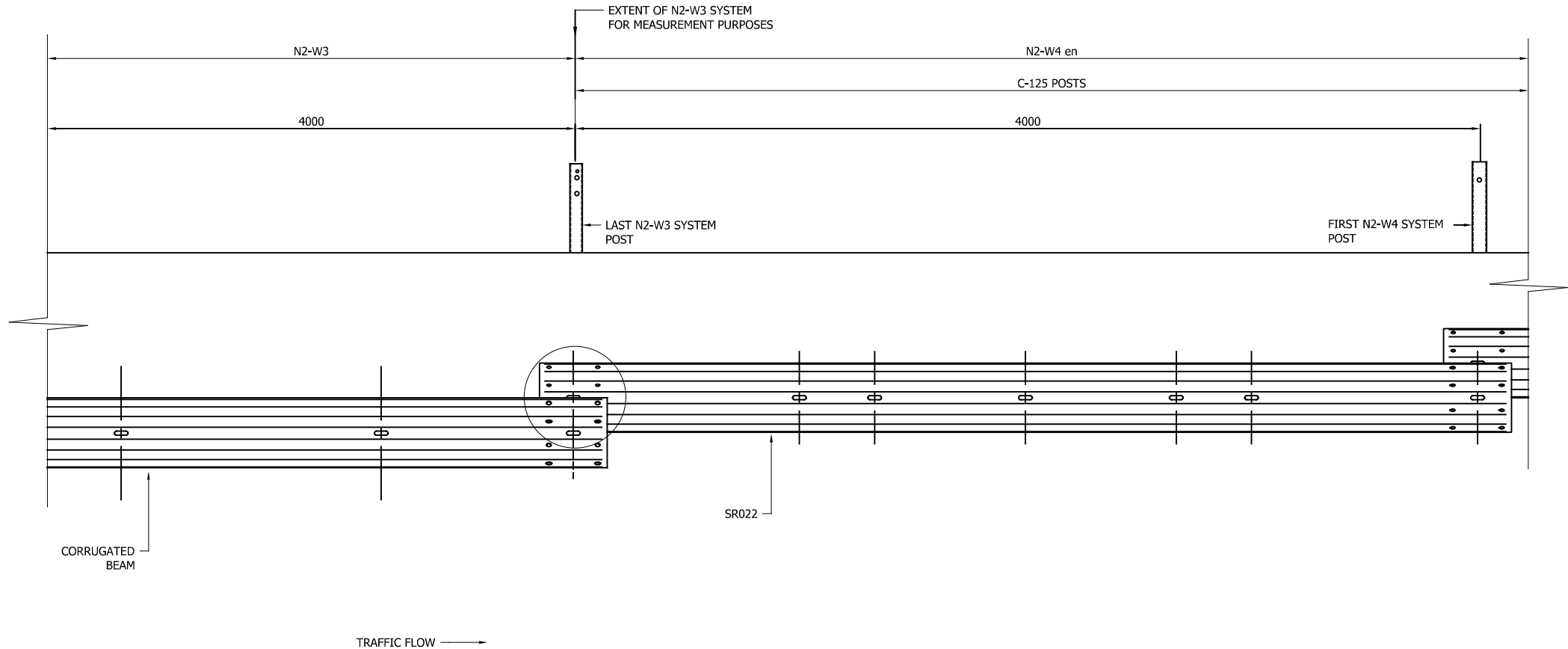

**NOTE:** BEAM ORIENTATION CIRCULAR HOLES TO BEAM APPROACH END

**\*\* BEAM REFERENCES** i.e. LEFT / RIGHT HAND ARE FOR VERGE INSTALLATIONS; FOR CENTRAL RESERVATION INSTALLATIONS THE REFERENCES ARE REVERSED

**GENERAL NOTES:**  
1. POSTS ARE TO BE INSTALLED WITH THE CLOSED FACE OF THE CHANNEL TOWARDS THE ON-COMING TRAFFIC.

**MegaRail en  
N2 W4**  
VEHICLE RESTRAINT SYSTEM.  
SYSTEM PROGRESSION SCHEMATIC  
FOR W4 PROTECTION TO HAZARD



CONCORD HOUSE,  
BESSEMER WAY, SCUNTHORPE,  
NORTH LINCOLNSHIRE, DN15 8XE  
t: 01724 289119  
FOR TECHNICAL ASSISTANCE CONTACT  
john.cudlipp@saferoad.co.uk

REVn	DATE	DETAILS	INITIAL
03	21/05/24	BEAM SLOTS REVISED	H.B
02	12/02/19	TITLEBLOCK REVISED	H.B
01	10/03/17	POST DESCRIPTION REV	L.L
00	30/01/17	NEW DRAWING	L.L

DRAWING NUMBER:	REVn:
N2W4en-GA-20	03

- GENERAL NOTES:
1. IF THE SITE CONDITIONS DO NOT ALLOW A POST TO BE INSTALLED ON THE SYSTEM PITCH DEVIATIONS CAN BE APPLIED. THE OBSTRUCTED POST CAN BE LEFT OUT AND EXTRA POSTS INSTALLED TO SPAN THE OBSTRUCTION AS PER THIS DRAWING. ALTHOUGH IT WOULD BE BENEFICIAL TO USE THE HOLES ALREADY IN THE BEAM IT IS ACCEPTABLE TO DRILL NEW HOLES IN THE DESIRED POSITIONS AND TREAT WITH ZINC RICH PAINT.
  2. OFFSET POSTS SHOWN ON DRAWING N2W4en-GA-00 CAN BE USED.

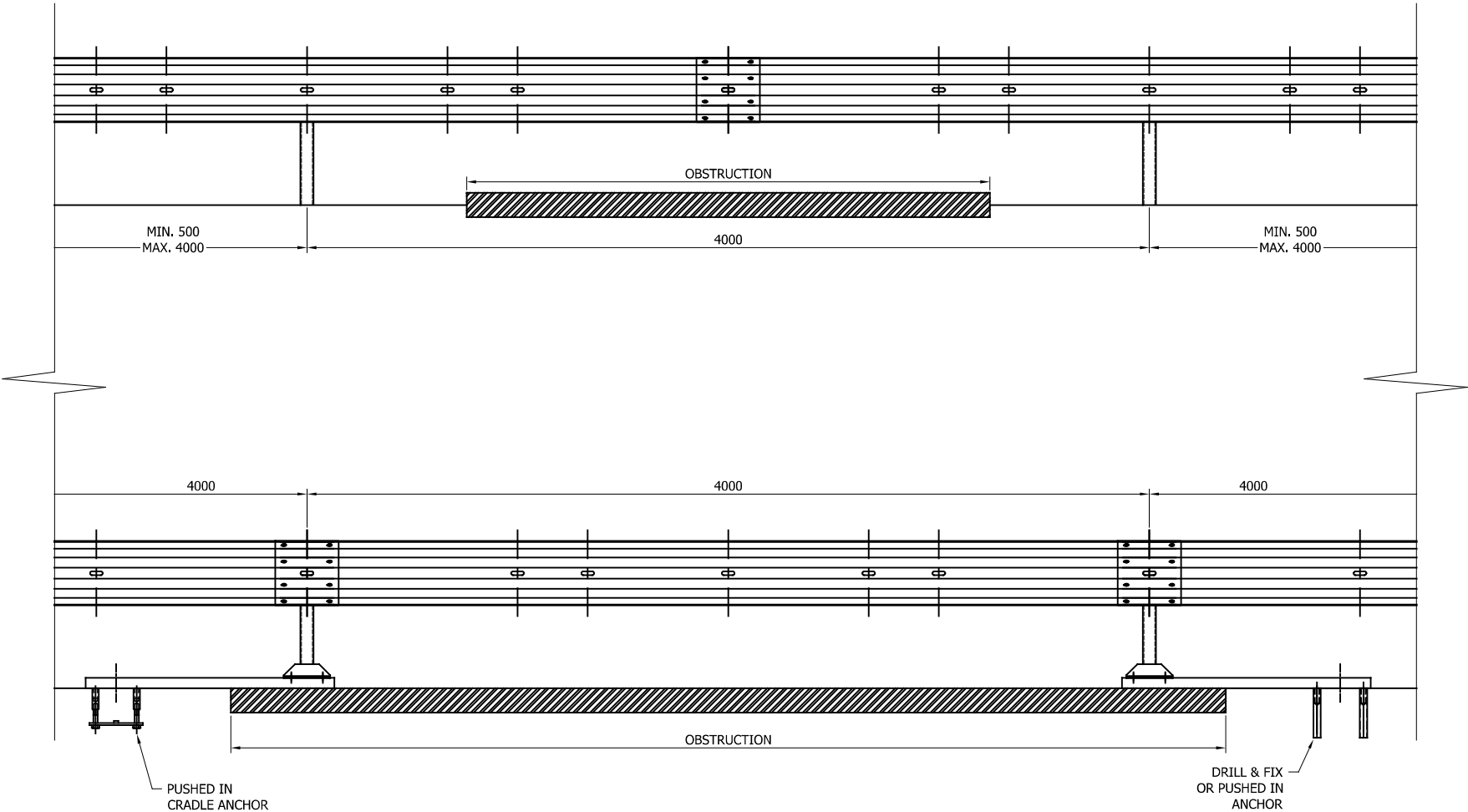

05	21/05/24	BEAM SLOTS REVISED	H,B
04	13/05/22	SURFACE MOUNTED POST BASE CHANGED	A,D
03	23/07/21	SURFACE MOUNTED POST DETAIL ADDED	A,D
02	25/05/21	DETAILS REVISED	M,T
01	12/02/19	TITLEBLOCK REVISED	H,B
00	30/01/17	NEW DRAWING	L,L
REVn	DATE	DETAILS	INITIAL

**MegaRail en**  
**N2 W4**  
N2.W4 VEHICLE RESTRAINT SYSTEM  
DEVIATION SETTING OUT  
ARRANGEMENT

**> SAFEROAD**  
CONCORD HOUSE,  
BESSEMER WAY, SCUNTHORPE,  
NORTH LINCOLNSHIRE, DN15 8XE  
t: 01724 289119  
FOR TECHNICAL ASSISTANCE CONTACT  
john.cudlipp@saferoad.co.uk

DRAWING NUMBER:	REVn:
N2W4en-GA-40	05