

Installation of Expansion Beams in MegaRail Safety Barrier Systems

Mega Rail safety barrier systems require expansion beams where there is a movement joint, this is applicable to all systems.

Some systems for example N2W4 ep cc6 or Mega Rail xn require expansion beams to be installed at regular specified intervals. Whichever is the case it is important to follow the procedure set out in this advice note.

Expansion beams are set to the correct length for ease of system installation and transport at the factory. This requires the fasteners on the beam section intended to dilate to be over tightened to hold the beam at the correct length such that it can be readily installed into the new safety barrier.

Once the expansion beam is installed and the lap bolts connecting the expansion beam to the adjacent beams are tightened it is important to follow the below steps.

1. Remove the locking nuts from the fasteners

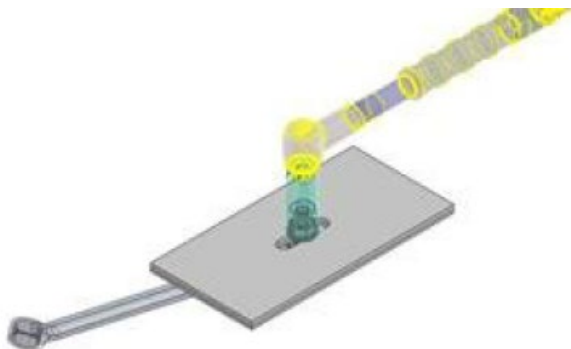

2. Tighten the inner nut to a maximum torque of 15Nm. You will need a crows foot torque wrench for this.

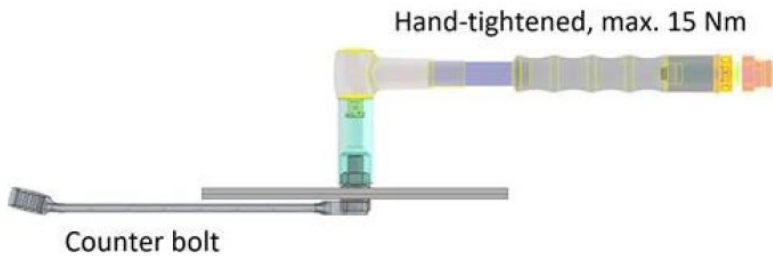

3. Replace the locking nut and tighten to 70Nm. It is important to hold the lower nut with a spanner to prevent the 15Nm torque being accidentally increased. You will need a crows foot torque wrench for this.

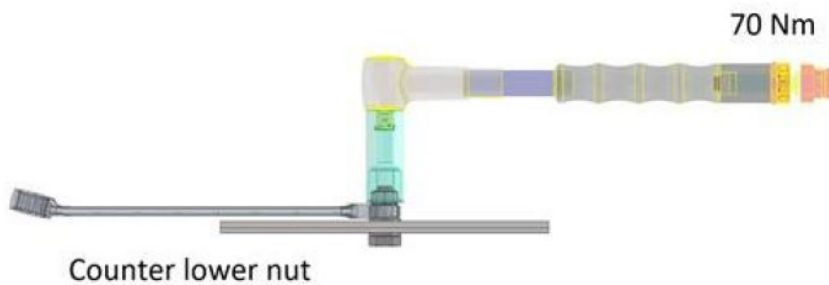

IMPORTANT:

FAILURE TO FOLLOW STEPS 1 TO 3 WILL PREVENT THE EXPANSION BEAM FROM WORKING AS INTENDED AND IN EXTREME HIGH TEMPRATURES LEAD TO DISTORTION FO THE FENCE LINE AND LEVEL

For more information contact – john.cudlipp@saferoad.co.uk
steve.duckworth@saferoad.co.uk

John Cudlip
Technical Director

25/06/2026